







AUTOMAX





**RUBICON**

**Jeep**  
WRANGLER

**AUTOMAX**

شارع المنامة  
Manana St













RUBICON



AUTOMAX  
AUTOMAX AS © 2014 BY JEEP LLC. 4011 4 220000













Jeep

AIRBAG

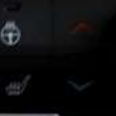







Jeep



SET +

CANC



RES

SET -









W 2.0 Vehicle Info 80°F

39 39  
39 38  
psi

Tyre pressure  
P  
26 km

H  
C

F  
E



ON OFF

OFF

FRONT WIPER

FRONT WIPER





2H  
4H 4L  
AUTO PAI TIM  
N

A gear selector display showing '2H', '4H', '4L', 'AUTO', 'PAI', 'TIM', and 'N'.



W 2.0 Vehicle Info 80°F

192°F

Coolant Temp

P 26 km

H C F E

A central digital display showing 'Vehicle Info' with '80°F' on the right. It features a coolant temperature gauge with '192°F' and 'Coolant Temp' text. Below it is a gear indicator showing 'P' and '26 km'. On the left is a fuel gauge with 'H' and 'C' markings. On the right is a fuel gauge with 'F' and 'E' markings. At the top, it shows 'W', '2.0', and a compass icon.







W 2.0 Vehicle Info 80°F

Oil Pressure  
29 psi

P  
26 km

The central display area includes a compass icon (W), a gear indicator (2.0), the text "Vehicle Info", and a temperature display (80°F). Below these are three gauges: a coolant level gauge (H to C), an oil pressure gauge (L to H) showing 29 psi, and a fuel level gauge (F to E). At the bottom, a gear indicator shows "P" and a range of 26 km.







W 2. Vehicle Info 80°F



Battery Voltage  
P  
26 km







2H  
4H  
4L

AUTO PART TIME

N

4L

W

3.0

Off Road

80°F

0°

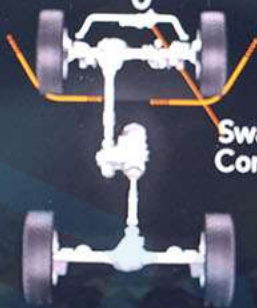

Drivetrain

P

26 km



ON OFF

OFF

OFF

OFF

A series of control buttons and switches, including a hazard light button, a parking brake button, and a gear shifter.





W 3.0 Off Road 80°F

Pitch & Roll  
26 km

The central display features two vehicle pitch and roll indicators, both showing 0°. It also includes a fuel gauge (E to F) and a water level gauge (C to H). The gear indicator shows 'P' (Park) and '26 km'.



ON OFF  
WIPER  
WIPER  
WIPER

Control stalks for wipers and other functions.



DO NOT PRESS

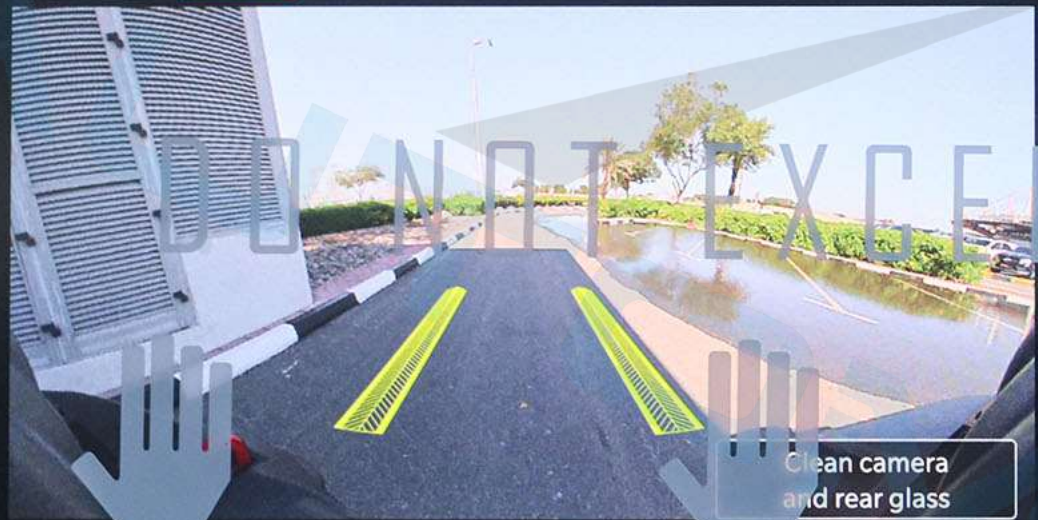

Clean camera and rear glass

Jeep





DO NOT PRESS

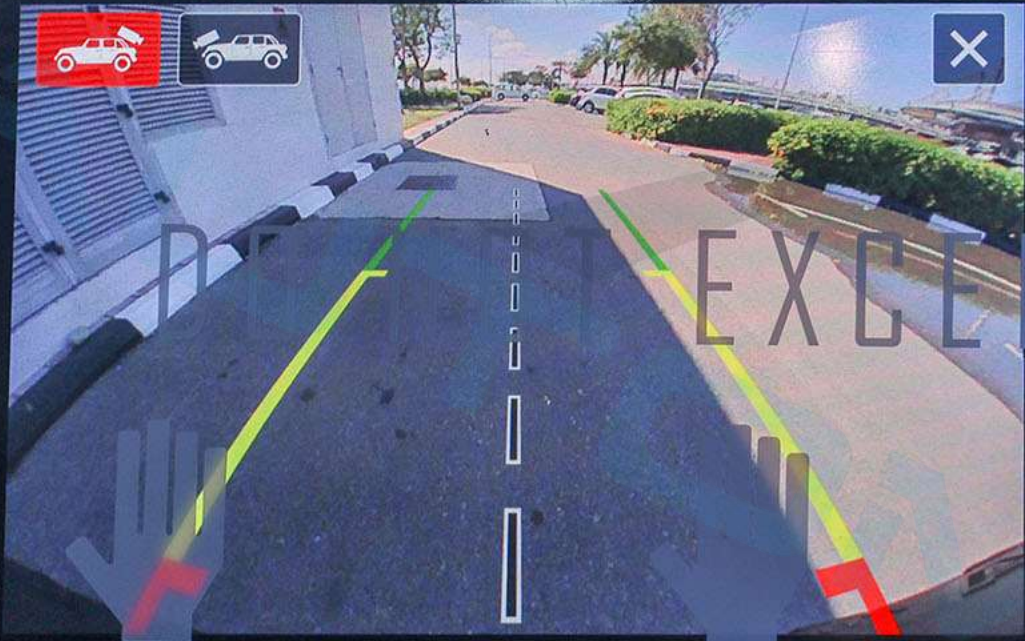

EXCEEDED Jeep





- Home
- Media
- Comfort
- Nav
- Phone
- Vehicle
- Apps

LO [Icons] 75° OUT | 10:53 | FM EmaratFM | [Icon] 69°

Search

Manama Street  
22 Street  
31 Street  
24d Street  
27c Street  
25c Street  
23 Street  
36c Street  
Nadd Al Hamar Road

DO NOT EXCEED 10Kg

3D [Speaker Icon] [Menu Icon]

40





DO NOT PRESS

- Home
- Media
- Comfort
- Nav
- Phone
- Vehicle
- Apps

LO 75° OUT | 10:53 EmaratFM | 69°

Favorites All

Media

Comfort

AM Radio

Audio Settings

Auxiliary Cable

Bluetooth

Nav

Phone

DAB

Device Manager

FM Radio

Media







Home



Media



Comfort



Nav



Phone



Vehicle



Apps

LO



75°  
OUT

10:53



EmaratFM



69°

DO NOT EXCEED 10 Kg



Heat



Heat

Max A/C

A/C

Rear

Sync

Off



1

2

3



4

5

6

7

Auto





DO NOT PRESS

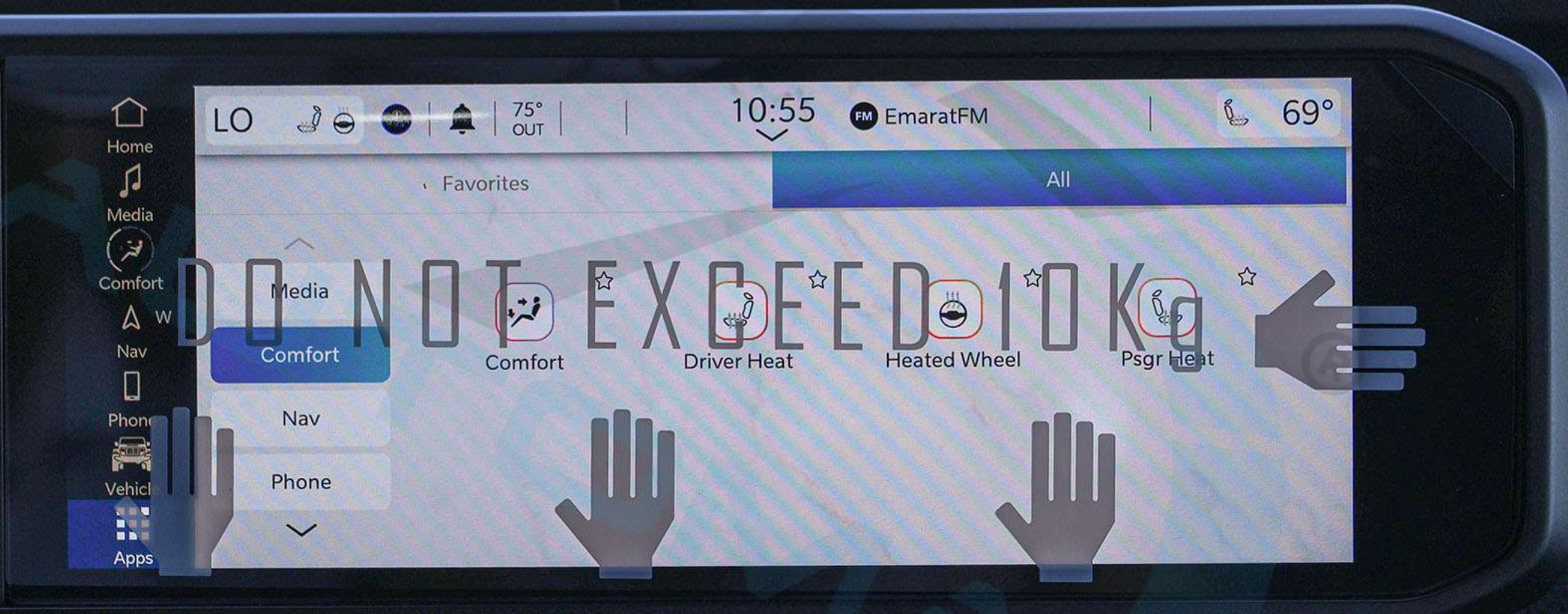

- Home
- Media
- Comfort
- Nav
- Phone
- Vehicle
- Apps

LO | [Icons] | 75° OUT | 10:55 | FM EmaratFM | [Icon] 69°

Favorites | All

Media

Comfort

Nav

Phone

Comfort

Driver Heat

Heated Wheel

Psgr Heat

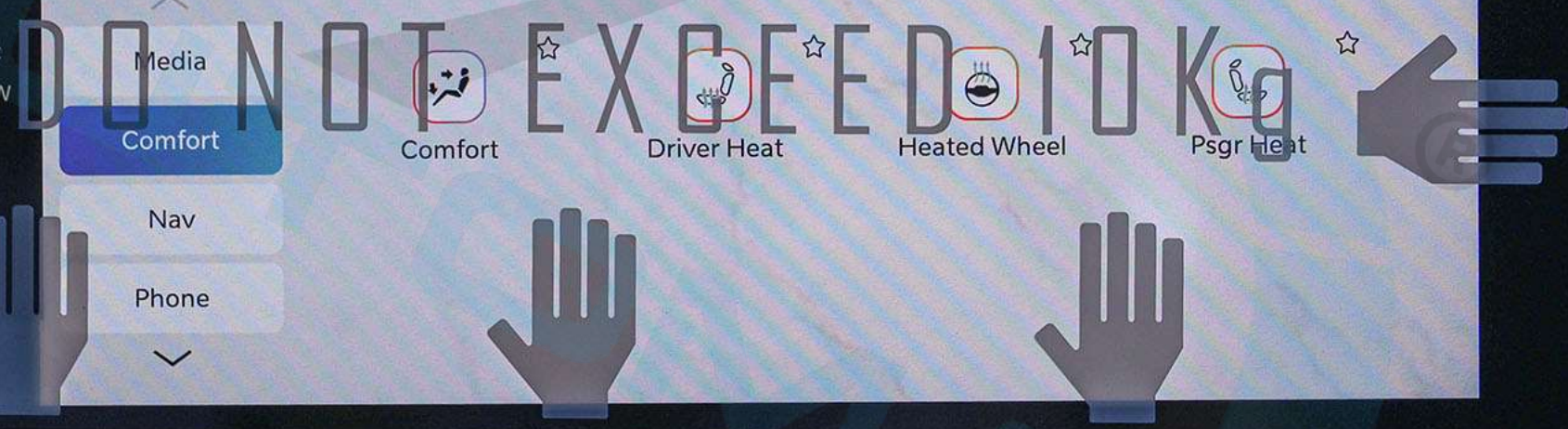



LO [Icons] 75° OUT | 10:52 FM EmaratFM | 69°

Dashboard

Controls

Settings

DO NOT EXCEED 10Kg

Mirror Dimmer

Forward Facing Camera

Rear View Camera

- Home
- Media
- Comfort
- Nav
- Phone
- Vehicle
- Apps

DO NOT PRESS

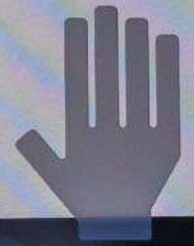



DO NOT PRESS

- Home
- Media
- Comfort
- Nav
- Phone
- Vehicle**
- Apps

LO | [Icons] | 75° OUT | 10:52 | FM EmaratFM | 69°

Dashboard | Controls | Settings

DO NOT EXCEED 100KG







Home



Media



Comfort



Nav



Phone



Vehicle



Apps

LO

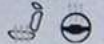

75°  
OUT

10:53



EmaratFM



69°

Favorites

All

DO NOT EXCEED 10Kg



Device Manager



Off Road Pages



Android Auto

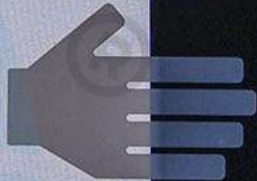

DO NOT PRESS



DO NOT PRESS

- Home
- Media
- Comfort
- Nav
- Phone
- Vehicle
- Apps

LO | 75° OUT | 10:53 | EmaratFM | 69°

Off Road Pages

Vehicle Dynamics

Steering Angle: [Value]

Transfer Case: Unlocked

Sway Bar: Connected

Front Axle Locker: Unlocked

Rear Axle Locker: Unlocked

Pitch & Roll

Front Camera

2H | 55°22'01" | 25°10'07" N | Altitude: -32 m

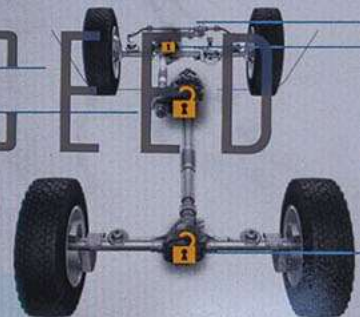

DO NOT EXCEED 10Kg



LO

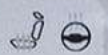

75°  
OUT

10:53

FM EmaratFM

69°

Off Road Pages

Vehicle Dynamics  
Accessory Gauges

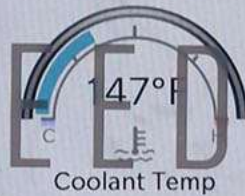
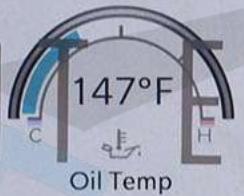

Pitch & Roll



Front Camera

2H 55°22'01" 25°10'07" N Altitude: -32 m



Home



Media



Comfort



Nav



Phone



Vehicle



Apps

DO NOT PRESS



DO NOT PRESS

- Home
- Media
- Comfort
- Nav
- Phone
- Vehicle
- Apps

Off Road Pages

DO NOT EXCEED 10kg

Vehicle Dynamics  
Accessory Gauges

Pitch & Roll

Front Camera

2H 55°22'01" E 25°10'07" N Altitude: -32 m

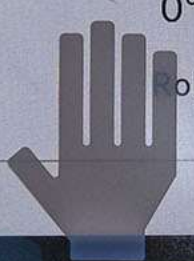



DO NOT PRESS

Home  
Media  
Comfort  
Nav  
Phone  
Vehicle  
Apps

LO 75° OUT | 10:54 EmaratFM | 69°

← Favorites All

Media DAB Device Manager FM Media

Comfort

Nav

Phone

USB 1 USB 2



DO NOT PRESS

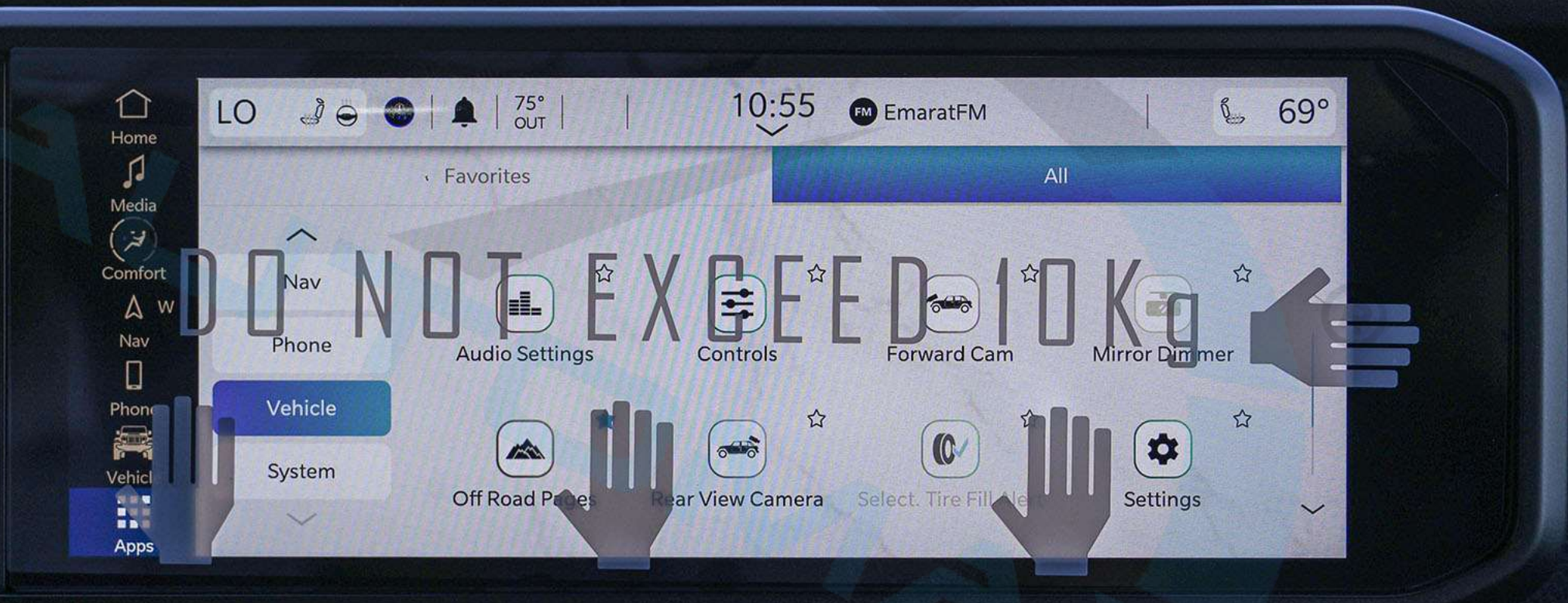

LO | 75° OUT | 10:55 | FM EmaratFM | 69°

Favorites | All

DO NOT EXCEED 100 KM/H

Nav | Phone | Audio Settings | Controls | Forward Cam | Mirror Dimmer

Vehicle | System | Off Road Pages | Rear View Camera | Select. Tire Fill | Settings



DO NOT PRESS

The image shows a car's infotainment screen with a home screen interface. The screen is framed by a black bezel with the text "DO NOT PRESS" on the left side. The interface includes a top status bar with "LO", weather icons, "75° OUT", the time "10:55", "FM EmaratFM", and "69°". Below the status bar is a "Favorites" section with a blue bar labeled "All". The main area contains several icons: "Nav", "Phone", "Driver Profiles", "Software Updates", and "Stored Notifications". A large, semi-transparent "DO NOT EXCEED 10K g" warning is overlaid across the center of the screen. The "Vehicle" menu is open, showing a "System" option. The "Apps" menu is visible at the bottom left. Hand icons are overlaid on the screen, indicating touch or gesture controls.

Home  
Media  
Comfort  
Nav  
Phone  
Vehicle  
Apps

LO | 75° OUT | 10:55 | FM EmaratFM | 69°

Favorites | All

Nav  
Phone  
Driver Profiles  
Software Updates  
Stored Notifications

DO NOT EXCEED 10K g

Vehicle  
System



DO NOT PRESS

- Главная
- Медиа
- Комфорт
- Nav 3
- Тел.
- Автом.
- Прил.

Низ. 75° НАРУЖИ | 10:55 | FM EmaratFM | 69°

Поиск

Manama Street

22 Street

31 Street

24d Street

27c Street

25c Street

23 Street

36c Street

Nadd Ali Hamar Road

DO NOT EXCEED 10Kg

40



DO NOT PRESS

- Главная
- Медиа
- Комфорт
- Nav
- Тел.
- АВТОМ
- Прил.

Низ. 75° НАРУЖН. 10:55 FM EmaratFM 69°

DO NOT EXCEED 10 Kg

Макс. А/С

A/C

Задний

Синхр.

Off

1

2

3

4

5

6

7

Авт.





- Главная
- Музыка
- Медиа
- Комфорт
- Nav
- Тел.
- Автом.
- Прил.

Низ. 75° НАРУЖН. | 10:55 FM EmaratFM | 69°

Приборная доска | Элементы управления | **Настройки**

Язык (Русский (Россия))

**Дисплей**

Режим дисплея: Авто (selected) / Ручной

Яркость дисплея в ночном режиме: 5

Яркость дисплея в дневном режиме: 10

Режим темы: Светл. / Темн. / Авто (selected)

DO NOT EXCEED 10Kg



- Главная
- Медиа
- Комфорт
- Nav
- Тел.
- Автом.**
- Прил.

Off Road Pages

**DO NOT EXCEED 10kg**

- Vehicle Dynamics
- Accessory Gauges
- Pitch & Roll**
- Front Camera



2H 55°22'01" N 25°10'07" E Высота -32 m



- Главная
- Медиа
- Комфорт
- Nav
- Тел.
- Автом.
- Прил.

Низ. 75° НАРУЖН. | 10:56 FM EmaratFM | 69°

Избранные Все

Медиа

Комфорт

Nav

Тел.

Медиа

Комфорт

Обог. пасс.

Обог. водит.

Обогрев. рул. колеса



DO NOT PRESS



- Главная
- Медиа
- Комфорт
- Nav
- Тел.
- Автом.
- Прил.

Низ. 75° НАРУЖН. 10:56 EmaratFM 69°

Избранные Все

DO NOT EXCEED 10Kg

Медиа

Комфорт

Nav

Тел.



Nav



DO NOT PRESS



- Главная
- Медиа
- Комфорт
- Nav
- Тел.
- Автом.
- Прил.

Низ. | 75° НАРУЖЕ | 10:56 | FM EmaratFM | 69°

Избранные | Все

DO NOT EXCEED 10Kg

Медиа

Комфорт

Телефон

Android Auto

Device Manager

Nav

Тел.

DO NOT PRESS





Низ. | | | | 75° НАРУЖН. | 10:56 | FM EmaratFM | 69°

Избранные | Все

Главная  
Медиа  
Комфорт  
Nav  
Тел.  
Автом.  
Прил.

Nav  
Тел.  
Автом.  
Система

Автом.  
Затемнение зеркала  
Камера зад. вида  
Настройки

Настройка аудио  
Передняя камера  
Переключатель сигнала...  
Элементы управления

DO NOT EXCEED 100 KM/H





Главная



Медиа



Комфорт

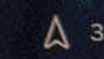

Nav



Тел.



Автом.



Прил.

Низ.



75°  
НАРУЖН.

10:56



69°

Источники

Воспроизведение

Просмотр

Настр. аудио

Баланс/  
Фейдер

Эквалайзер

Гром. в завис.  
от скорости

Компенсац.  
громкости Аиx



DO NOT EXCEED 100 km/h

DO NOT PRESS



FLY

Volume control knob with 'VOLUME' and power symbols.

FRONT	Icon of a person with a seatbelt	Red up arrow	OFF	Red up arrow	MODE	A/C
Icon of a car with a seatbelt	Icon of a car with a seatbelt and a person	Blue down arrow	AUTO	Blue down arrow	Icon of a hand	Icon of a car

MUTE    A OFF    OFF    P OFF    SCREEN OFF

TUNE BROWSE ENTER SCROLL

Lower dashboard controls including a central button with a car icon and other buttons.





MEDIA



OFF

FRONT+REAR

REAR ONLY

OFF

OFF

AUX 3

AUX 4





























///ALPINE



















**Jeep**®

DOT H0388FKC-NH-7498

ASH 23



43R-0120269



EQ001488



23



SAH ACOUSTIC

TRANSP. 70% MIN.

MADE IN USA

PG2519035AA

**CORNING | Gorilla Glass**





**RUBICON®**

A close-up photograph of the 'RUBICON' badge on a white vehicle. The badge is rendered in a bold, black, sans-serif font with a prominent red outline. A registered trademark symbol (®) is positioned to the upper right of the letter 'N'. The badge is mounted on a white, curved surface, likely the rear of a truck or SUV. In the background, a blurred green hedge with some red flowers is visible under bright, natural light.







**Jeep**  
**WRANGLER**





TRAIL  
RATED



4x4





Manufacturer Name **FCA US LLC** اسم المصنع  
Model Year **2024** سنة الموديل Label No **160987** رقم البطاقة

Vehicle Type **FCA US LLC JEEP WRANGLER UNLIMITED 3.6L SUV 4WD 4Doors** طراز المركبة

Fuel Economy **اقتصاد الوقود**



 <b>هيئة التقييس</b> لدول مجلس التعاون لدول الخليج العربية GCC Standardization Organization	Fuel Type <b>بنزين Gasoline Euro IV</b> نوع الوقود	
	Fuel Economy <b>9.4 km/L</b> اقتصاد الوقود	
	Vehicle Class <b>Light Truck</b> فئة المركبة	

إزالة أو تغطية أو إتلاف هذه البطاقة قبل البيع يعرض للملاحقة القانونية  
Removing, covering or damaging this label before sale is punishable by law











**Jeep**  
WRANGLER

BF GOODRICH  
ALL-TERRAIN  
T/A KO2





RUBICON

AUTOMAX

keep





لمشاهدة صورة السيارة بزاوية 360 درجة إضغط على الصورة أعلاه

Для просмотра автомобиля в формате 360°, пожалуйста, нажмите на фото выше.

To view the 360° degree please press on the picture above



# 2024 JEEP WRANGLER UNLIMITED RUBICON XTREME V6 3.6L GCC 0km

Бренд: Jeep

Brand: Jeep

الماركة جيب

Категория: Wrangler Unlimited

Category : Wrangler Unlimited

الفئة: رانجلر أنلملتد

Модель: Rubicon Xtreme

Model : Rubicon Xtreme

الموديل: روبيكون اكستريم

Год: 2024

Year: 2024

السنة: 2024

Километров: 0 Km

Kilometers: 0 Km

كيلومترات: 0 كم

Двери: 4 Doors

Doors: 4 Doors

عدد الأبواب: أربعة أبواب

Цвет: Белый

Color: Bright White

اللون : أبيض

Цилиндр: 6 Cylinders

Cylinder: 6 Cylinders

عدد الأسطوانات: 6 أسطوانات

Лошадиные силы: 285 HP

Horsepower: 285 HP

عدد الأحصنة: 285 حصان

Трансмиссия: Автоматическая

Transmission: Automatic

نوع النقل : نقل أوتوماتيكي

Топливо: Бензин

Fuel: Gasoline

المواصفات الإقليمية: خليجية

4X4

4 Wheel Drive 4X4

نوع الوقود: بنزين

دفع رباعي 4X4



# 2024 JEEP WRANGLER UNLIMITED RUBICON XTREME V6 3.6L GCC 0km

NAPPA LEATHER SEATS

BLACK

MIDDLE EAST EQUIPMENT GROUP

XTREME 35 TIRE PACKAGE

CONVENIENCE GROUP

TECHNOLOGY GROUP

SAFETY GROUP

SMOKER'S GROUP

FMVSS MIDDLE EAST GROUP

AUX BATTERY

SELEC-SPEED (TM) CONTROL

ANTI-LOCK 4-WHEEL DISC PERF BRAKES

PREMIUM DOOR TRIM PANEL

MOPAR HARDTOP HEADLINER

FREEDOM PANEL STORAGE BAG

REMOVABLE ASH TRAY

LEATHER WRAPPED PARK BRAKE HANDLE

LEATHER WRAPPED SHIFT KNOB

MOPAR JACK SPACER

#1 SEAT FOAM CUSHION

ALL AUTOMATIC TRANSMISSIONS

8-SPD AUTO 850RE TRANS (MAKE)

4:1 ROCK-TRAC HD FULL TIME 4WD SYS

4.56 REAR AXLE RATIO

3.6L V6 24V VVT ENGINE UPG I W/ESS

SOLAR CONTROL GLASS

REAR WINDOW DEFROSTER

REAR VIEW AUTO DIM MIRROR

BODY COLOR 3-PIECE HARD TOP

200 KPH PRIMARY SPEEDOMETER

REAR WINDOW WIPER/WASHER

CIGAR LIGHTER

230V AUXILIARY POWER OUTLET

GPS NAVIGATION

AIR FILTERING

HEATED FRONT SEATS

POWER 4-WAY DRIVER LUMBAR ADJUST

POWER 4-WAY PASSENGER LUMBAR ADJUST

DRIVER SEAT - POWER ADJUST 8-WAY

FRT PASS SEAT - POWER ADJUST 8-WAY



# 2024 JEEP WRANGLER UNLIMITED RUBICON XTREME V6 3.6L GCC 0km

EXTERIOR MIRRORS W/ARABIC LETTERING

AUTO HIGH BEAM HEADLAMP CONTROL

REAR FOG LAMPS

FRONT WIDE LICENSE PLATE BRACKET

WRANGLER DECAL

BODY COLOR RUBICON HIGHLINE FLARE

EXPORT EMISSIONS

U.S. EMISSIONS W/OBD 1

ENGINE OIL COOLER

HEATED STEERING WHEEL

ADAPTIVE CRUISE CONTROL W/STOP

WHEEL FLARE EXTENSIONS

BRIGHT WHITE CLEAR COAT

ALPINE PREMIUM AUDIO SYSTEM

APPLE CARPLAY

DISASSOCIATED TOUCHSCREEN DISPLAY

GOOGLE ANDROID AUTO

12.3" TOUCHSCREEN DISPLAY

DIGITAL AUDIO BROADCASTING

INTEGRATED CENTER STACK RADIO

ALL R1 HIGH RADIOS

35" TIRE SUSPENSION

LT315/70R17C 113/110S TIRES

BF GOODRICH BRAND TIRES

UCONNECT 5 NAV W 12.3" DISP(ROW+DAB)

17X8.0 MACHINED WHEELS W/BLK POCKETS

ALL ALUMINUM WHEELS

PARKSENSE REAR PARK ASSIST SYSTEM

BLIND SPOT AND CROSS PATH DETECTION

REMOTE START SYSTEM

TIP START

MOPAR HINGE-GATE REINFORCEMENT

MOPAR TIRE RELOCATION KIT

STOP-START DUAL BATTERY SYSTEM

LOCK FUEL CAP W/ DISCRIMINATOR

ARABIC LANGUAGE

INTEGRATED OFF-ROAD CAMERA

INTEGRATED VOICE COMMAND W/BLUETOOTH

MANUF STATEMENT OF ORIGIN

4 ADDITIONAL GALLONS OF GAS



# 2024 JEEP WRANGLER UNLIMITED RUBICON XTREME V6 3.6L GCC 0km

BEAD-LOCK

Gorilla Glass Windshield

NAPPA LEATHER SEATS

Зимний Пакет

Подогрев Сидений

Рулевое Колесо с Подогревом

Боковые Зеркала с Подогревом

Дистанционный Запуск Двигателя

Система Мониторинга Слепых Зон

Бесключевой Доступ

Регулировка Режимов Вождения

Ограничитель Скорости

Адаптивный Круиз-контроль

камера переднего вида

Камера Заднего Вида

Блокировка Дифференциала

ALPINE Премиальная Мультимедийная Система

Датчик Давления в Шинах

Система «Старт-Стоп»

12.3 Сенсорный Экран

Apple CarPlay

Android Auto



# 2024 JEEP WRANGLER UNLIMITED RUBICON XTREME V6 3.6L GCC 0km

الأداء:

ناقل حركة أوتوماتيكي ب 8 سرعات

سعة المحرك: 3.6 لتر

عدد الأسطوانات: 6 أسطوانات

عدد الأحصنة: 285 حصان

العزم: 353 نيوتن/متر

دفع رباعي

\* المواصفات الإضافية:

BEAD-LOCK

Gorilla Glass Windshield

Off-Road Pages

مراتب سوداء من جلد النابا

مثبت سرعة تكييفي

نظام الدفلوك Differential Lock

خاصية الثبات الإلكتروني SWAY BAR

خاصية الطرقات الوعرة Off-Road Plus

كاميرا أمامية + خلفية

وضعية قيادة متعددة

نظام البطارية المزدوج للبدء والتوقف

خاصية الكشف عن النقطة العمياء

عوازل حرارية للسقف

نظام صوتي متقدم من Alpine

خاصية تدفئة المراتب

خاصية تدفئة المقود

خاصية تسخين المرايا الجانبية



# 2024 JEEP WRANGLER UNLIMITED RUBICON XTREME V6 3.6L GCC 0km

دخول بصمة  
التشغيل عن بعد  
نظام تحديد المواقع والملاحة  
وسائد هوائية أمامية  
مآخذ كهربائية إضافية  
فرامل متقدمة عالية الأداء  
تكييف هواء مع تحكم تلقائي بدرجة الحرارة  
عجلات قياس 17 بوصة

نظام للمساعدة على الركن الخلفي  
شاشة كبيرة تعمل باللمس مقاس 12.3 بوصة  
آمر صوتي متكامل مع بلوتوث  
مثبت سرعة  
إنارة LED  
اللغة العربية  
مراتب كهربائية متعددة الوضعيات  
أبل كاربلاي + أندرويد أوتو



# AUTOMAX®

The Boutique Of Muscle Cars, Truck Fanatics & German Automotive Experts.



تتكلم اللغة العربية

**WE SPEAK ENGLISH**

**ON PARLE LE FRANCAIS**

**Nosotros hablamos español**

**мы говорим по-русски**

**biz o'zbek tilida**

**gaplashamiz**

**हम हिंदी बोलते हैं**



**automaxgroup.me**



**automax group**



**automax.dxb**



**Automax\_LLC**



**+971 50 602 7200**



**automax.dxb**



**automax.dxb**



**automax.dxb**



**automax\_dxb**



**automax group L.L.C**

**New Auto Market - Dubai - United Arab Emirates**

**Directions**