







RUBICON

Jeep





AUTOMAX
AUTOMAX.AE ©-1971 84 279 8000 & 1971 4 2200000



AUTOMAX
AUTOMAX.ae

0-111 34 371 800 ☎ 011 4 220688







Jeep

Audio 77°F

STAR FM
FM 99.50 MHz

70° 4:55 STAR FM

Dashboard Controls

DO NOT EXCEED
Mirror Dimmer Forward Facing Camera

- Home
- Media
- Comfort
- NE
- Nav
- Phone
- Vehicle
- Apps

CLIMATE CONTROL CONTROLS

ILLUSTRATION: A hand icon is shown near the 'DO NOT EXCEED' warning on the infotainment screen.

DRIVE MODE SELECTION CONTROLS

ILLUSTRATION: A hand icon is shown near the 'DO NOT EXCEED' warning on the infotainment screen.

AUXILIARY PORTS AND MEDIA CONTROLS

ILLUSTRATION: A hand icon is shown near the 'DO NOT EXCEED' warning on the infotainment screen.



ep



SET +

CANC



RES

SET -

OFF
FRONT WIPER
MIST
REAR WIPER



W 1.0 Speedometer 80°F

0 km/h

OK for MPH

P 26 km

C E

A central digital display showing a compass (W), gear selection (1.0), speedometer (0 km/h), temperature (80°F), and gear (P). It also displays a range of 26 km and fuel level indicators (C, E).



ON OFF

WIPERS

WASHER

A control stalk for wipers and washer, with ON and OFF positions and symbols for wiper and washer functions.



W 2.0 Vehicle Info 80°F

39 39
39 38
psi

Tyre pressure
P
26 km

H
C
F
E



ON OFF

OFF

FRONT WIPER



W 2.0 Vehicle Info 80°F

192°F

Coolant Temp

P 26 km

F
E





W 2.0 Vehicle Info 80°F

Oil Pressure 29 psi

P 26 km

The central display area shows a compass pointing North (W), a gear indicator for 2.0, and a temperature of 80°F. The oil pressure gauge shows 29 psi. The fuel gauge shows approximately 1/4 tank. The odometer shows 26 km. A green oil pressure indicator is lit.





W

2.0

Vehicle Info

80°F



Battery Voltage

P
26 km





2H
4H
4L
AUTO PART TIME
N

W

3.0

Off Road

80°F

0°

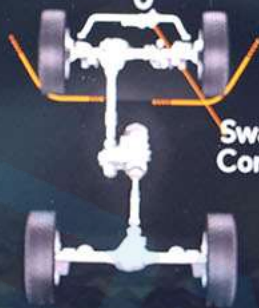

Drivetrain

P

26 km



ON OFF
OFF
OFF

A control panel with several buttons and switches, including "ON", "OFF", and "OFF".



W 3.0 Off Road 80°F

H C F E

Pitch & Roll
0° 0°

P
26 km

The central instrument cluster displays a compass pointing West (W), a gear indicator for 3.0, and an 'Off Road' mode. It features two vehicle pitch and roll indicators, both showing 0°. A fuel gauge is visible on the right side of the cluster, and a 'P' (Park) indicator is shown at the bottom.



ON OFF

WIPER

REAR WIPER

The bottom right of the image shows the wiper control stalk with 'ON' and 'OFF' positions for both front and rear wipers.

DO NOT PRESS

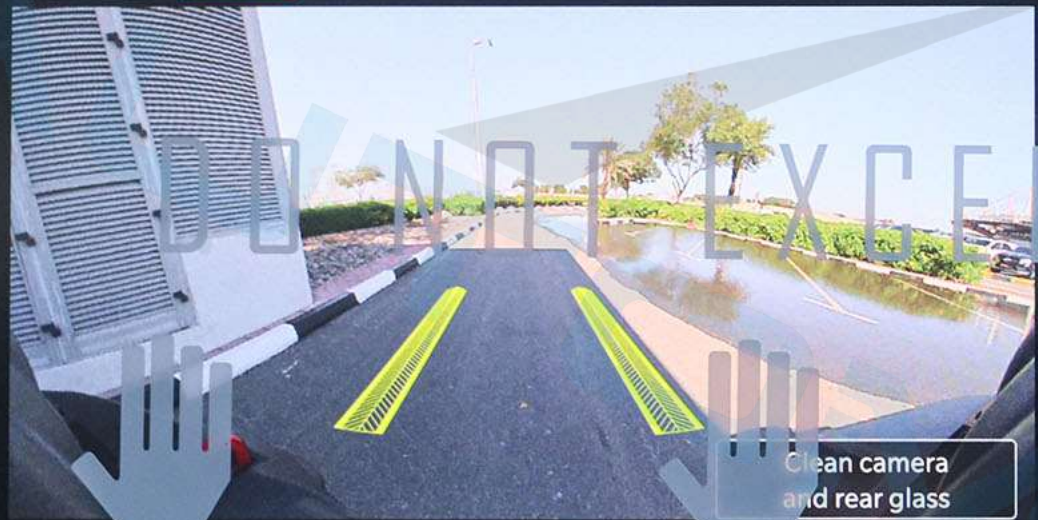

Clean camera and rear glass

Jeep



DO NOT PRESS

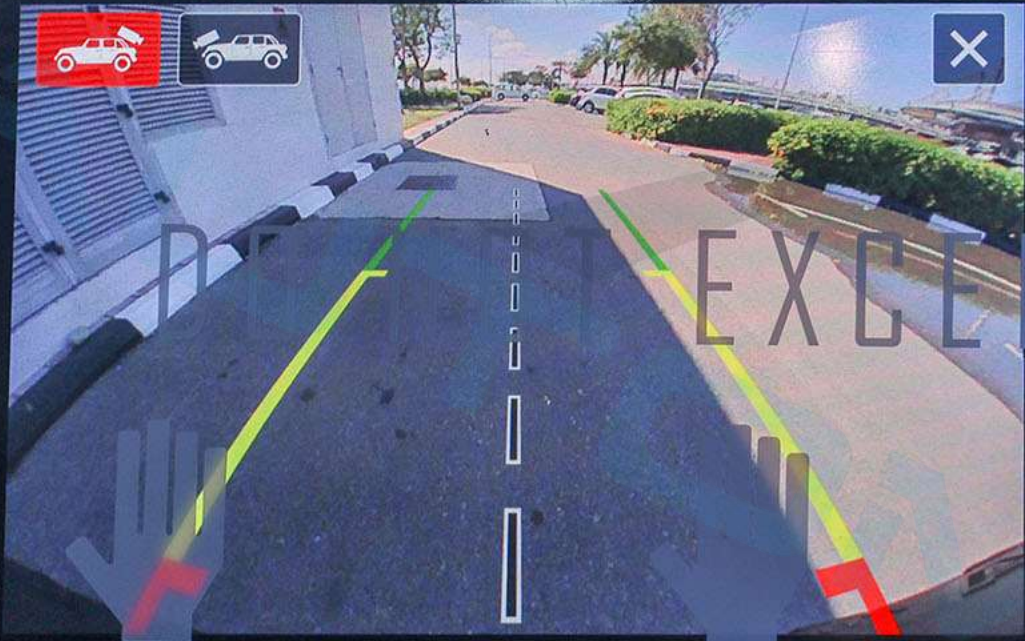

EXCELED Jeep





Home



Media



Comfort



Nav



Phone



Vehicle



Apps

LO

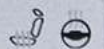

75°
OUT

10:53



EmaratFM



69°

Search

DO NOT EXCEED 10Kg



40

Manama Street

22 Street

31 Street

24d Street

27c Street

25c Street

23 Street

36c Street

Nadd AlHamar Road

DO NOT PRESS

- Home
- Media
- Comfort
- Nav
- Phone
- Vehicle
- Apps

LO 75° OUT | 10:53 EmaratFM | 69°

Favorites All

Media

- Comfort
- Nav
- Phone

AM AM Radio Audio Settings Auxiliary Cable Bluetooth

DAB DAB Device Manager FM FM Radio Media

DO NOT EXCEED 100km/h





Home



Media



Comfort



Nav



Phone



Vehicle



Apps

LO



75°
OUT

10:53



EmaratFM



69°

DO NOT EXCEED 10 Kg



Heat



Heat

Max A/C

A/C

Rear

Sync

Off



1

2

3



4

5

6

7

Auto



DO NOT PRESS

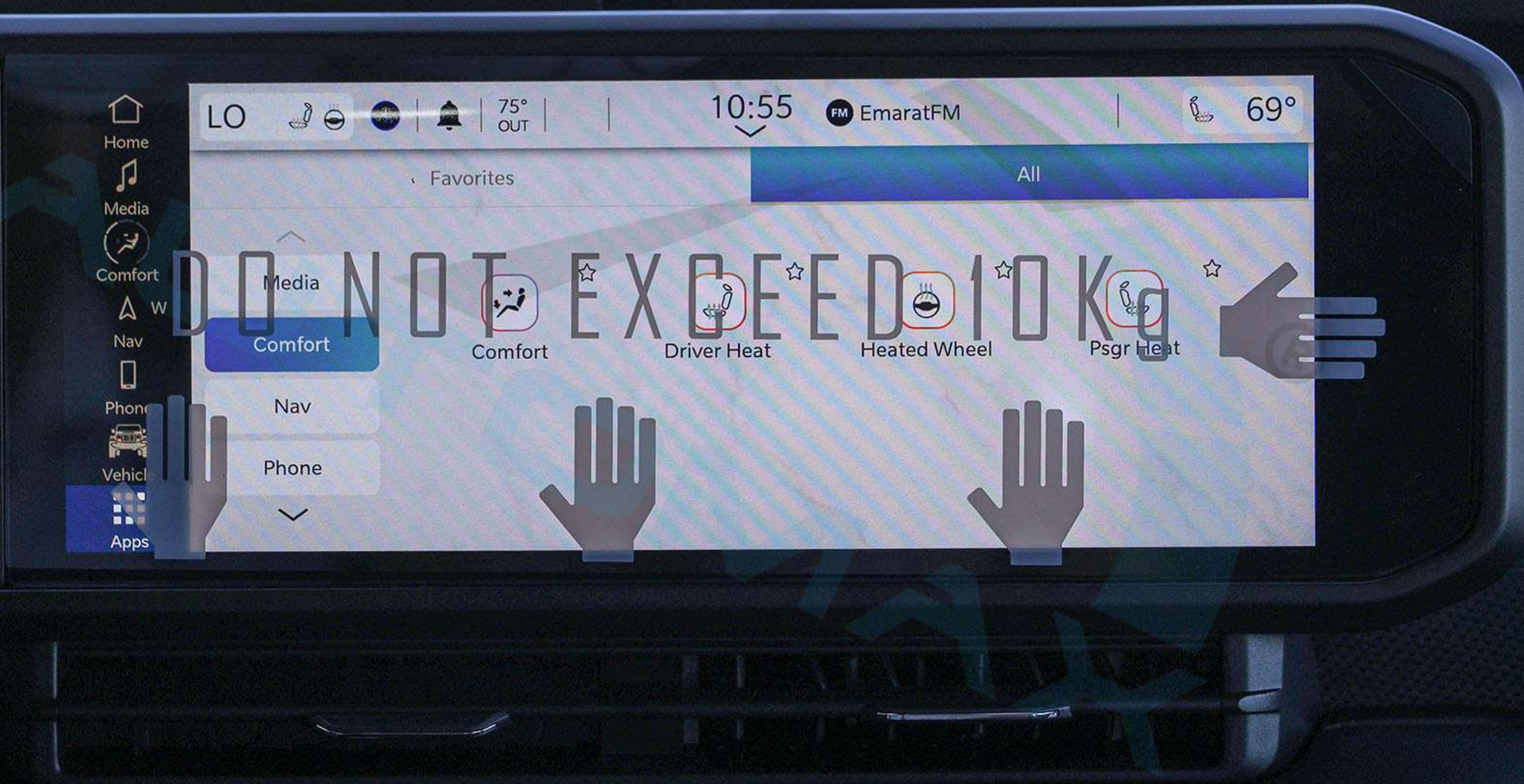

LO



75°
OUT

10:55



EmaratFM



69°

Favorites

All

Media

Comfort

Nav

Phone

Apps

Comfort

Driver Heat

Heated Wheel

Psgr Heat

DO NOT EXCEED 10 Kg

LO [Icons] 75° OUT | 10:52 FM EmaratFM | 69°

Dashboard

Controls

Settings

DO NOT EXCEED 10Kg

Mirror Dimmer

Forward Facing Camera

Rear View Camera

- Home
- Media
- Comfort
- Nav
- Phone
- Vehicle
- Apps

DO NOT PRESS

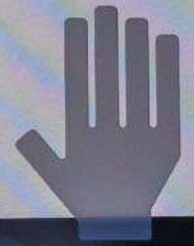

DO NOT PRESS



Home



Media



Comfort



Nav



Phone



Vehicle



Apps

LO

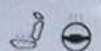

75°
OUT

10:52

FM EmaratFM

69°

Dashboard

Controls

Settings



OFFROAD
PAGE

DO NOT EXCEED 10KG





Home



Media



Comfort



Nav



Phone



Vehicle



Apps

LO

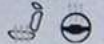

75°
OUT

10:53



EmaratFM



69°

Favorites

All

DO NOT EXCEED 10Kg



Device Manager



Off Road Pages



Android Auto

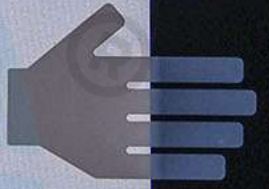

DO NOT PRESS

- Home
- Media
- Comfort
- Nav
- Phone
- Vehicle
- Apps

LO | 75° OUT | 10:53 | EmaratFM | 69°

Off Road Pages

Vehicle Dynamics

Steering Angle: [Value]

Transfer Case: Unlocked

Sway Bar: Connected

Front Axle Locker: Unlocked

Rear Axle Locker: Unlocked

Pitch & Roll

Front Camera

2H | 55°22'01" | 25°10'07" N | Altitude: -32 m

DO NOT EXCEED 10Kg

DO NOT PRESS

LO

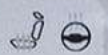

75°
OUT

10:53

FM EmaratFM



69°

Off Road Pages

Vehicle Dynamics
Accessory Gauges

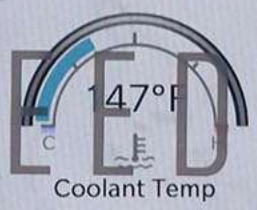
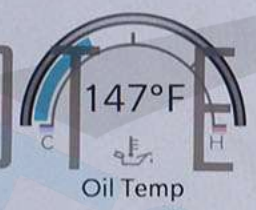

Pitch & Roll



Front Camera

2H 55°22'01" 25°10'07" N Altitude: -32 m



Home



Media



Comfort



Nav



Phone



Vehicle



Apps

DO NOT PRESS

DO NOT PRESS

- Home
- Media
- Comfort
- Nav
- Phone
- Vehicle
- Apps

Off Road Pages

DO NOT EXCEED 10kg

Vehicle Dynamics
Accessory Gauges

Pitch & Roll

Front Camera

2H 55°22'01" E 25°10'07" N Altitude: -32 m

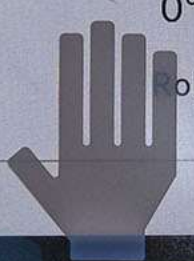

DO NOT PRESS

The image shows a car's infotainment screen with a light blue background. At the top, there is a status bar with icons for LO, a signal strength indicator, a battery icon, a bell icon, and a temperature of 75° OUT. The time is 10:54, and the radio is tuned to EmaratFM. On the right, there is a weather icon and a temperature of 69°. Below the status bar, there are two tabs: 'Favorites' and 'All'. The main area contains several app icons: 'Media' (with a star), 'DAB' (with a star), 'Device Manager' (with a star), 'FM Radio' (with a star), and 'Media' (with a star). Below these are 'Nav' and 'Phone' options. At the bottom, there are 'USB 1' and 'USB 2' icons. On the left side of the screen, there is a vertical navigation menu with icons for Home, Media, Comfort, Nav, Phone, Vehicle, and Apps. The 'Apps' icon is highlighted in blue. There are several hand icons overlaid on the screen, indicating touch gestures.

- Home
- Media
- Comfort
- Nav
- Phone
- Vehicle
- Apps

DO NOT PRESS

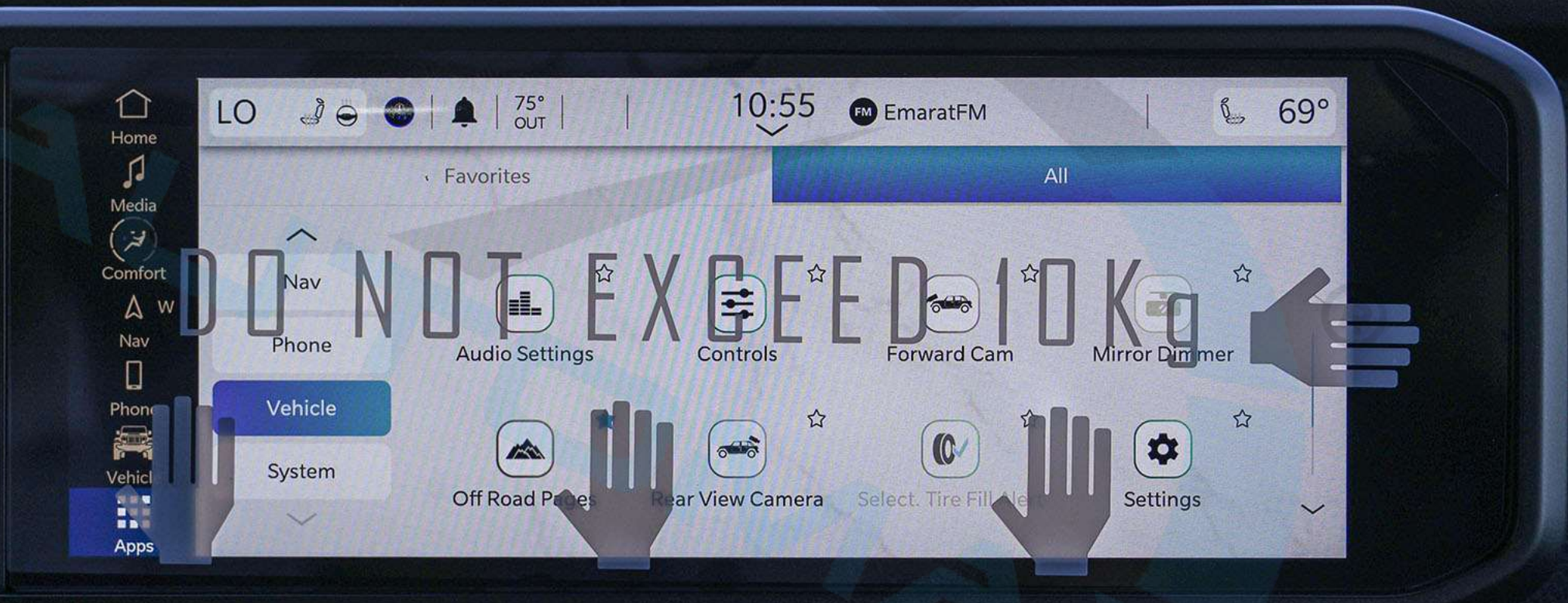

- Home
- Media
- Comfort
- Nav
- Phone
- Vehicle
- Apps

LO | [Weather Icons] | [Bell Icon] | 75° OUT | 10:55 | FM EmaratFM | [Weather Icon] 69°

Favorites | All

DO NOT EXCEED 100 KM/H

Nav | Phone | Audio Settings | Controls | Forward Cam | Mirror Dimmer

Vehicle | System | Off Road Pages | Rear View Camera | Select. Tire Fill | Settings

DO NOT PRESS

The image shows a car's infotainment screen with a home screen interface. The screen is framed by a black bezel with the text "DO NOT PRESS" on the left side. The interface includes a top status bar with "LO", weather icons, "75° OUT", the time "10:55", "FM EmaratFM", and "69°". Below the status bar is a "Favorites" section with a blue bar labeled "All". The main area contains several icons: "Nav", "Phone", "Driver Profiles", "Software Updates", and "Stored Notifications". A large, semi-transparent "DO NOT EXCEED 100Kph" warning is overlaid across the center. On the left side, there is a vertical menu with icons for "Home", "Media", "Comfort", "Nav", "Phone", "Vehicle", and "Apps". The "System" option is highlighted in a blue bar. Three hand icons are overlaid on the screen, indicating touch interaction points.

- Home
- Media
- Comfort
- Nav
- Phone
- Vehicle
- Apps

LO | 75° OUT | 10:55 | FM EmaratFM | 69°

Favorites | All

DO NOT EXCEED 100Kph

- Nav
- Phone
- Driver Profiles
- Software Updates
- Stored Notifications

- Vehicle
- System

DO NOT PRESS

Главная

Медиа

Комфорт

Nav 3

Тел.

Автом.

Прил.

Низ. 75° НАРУЖИ 10:55 FM EmaratFM 69°

Поиск

DO NOT EXCEED 10K g

3D

Manama Street
22 Street
31 Street
24d Street
27c Street
25c Street
23 Street
36c Street

Nadd Ali Hamar Road

40

DO NOT PRESS

- Главная
- Медиа
- Комфорт
- Nav
- Тел.
- АВТОМ
- Прил.

Низ. 75° НАРУЖН. 10:55 FM EmaratFM 69°

DO NOT EXCEED 10 Kg

Макс. А/С

A/C

Задний

Синхр. Off 1 2 3 4 5 6 7 Авт.

- Главная
- Медиа
- Комфорт
- Nav
- Тел.
- Автом.
- Прил.

Низ. 75° НАРУЖН. 10:55 FM EmaratFM 69°

Приборная доска | Элементы управления | **Настройки**

Язык (Русский (Россия))

Дисплей

Режим дисплея: Авто (selected) | Ручной

Яркость дисплея в ночном режиме: 5

Яркость дисплея в дневном режиме: 10

Режим темы: Светл. | Темн. | Авто (selected)

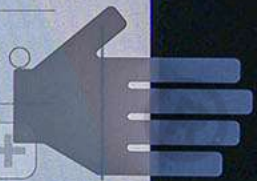
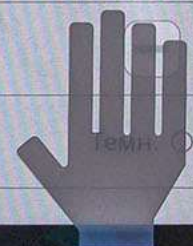
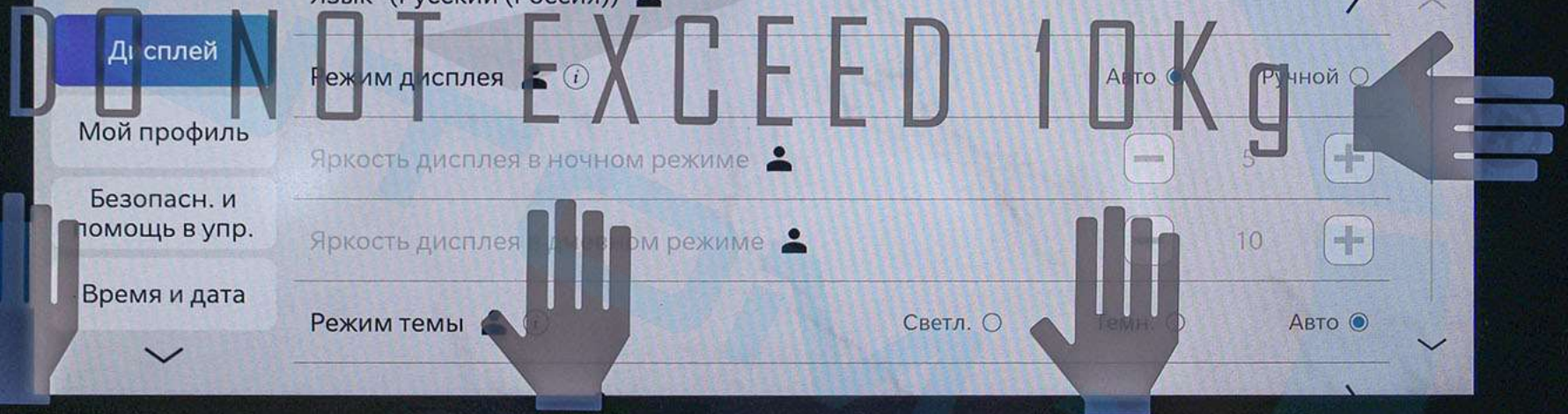

- Главная
- Медиа
- Комфорт
- Nav
- Тел.
- Автом.**
- Прил.

Off Road Pages

DO NOT EXCEED 10kg

Vehicle Dynamics
Accessory Gauges

Pitch & Roll

Front Camera

0°
Pitch

0°
Roll

2H 55°22'01" N 25°10'07" E Высота -32 m

- Главная
- Медиа
- Комфорт
- Nav
- Тел.
- Автом.
- Прил.

Низ. 75° НАРУЖН. 10:56 FM EmaratFM 69°

Избранные Все

- Медиа
- Комфорт
- Nav
- Тел.
- Комфорт
- Обог. пасс.
- Обог. водит.
- Обогрев. рул. колесо



- Главная
- Медиа
- Комфорт
- Nav
- Тел.
- Автом.
- Прил.

Низ. 75° НАРУЖН. 10:56 EmaratFM 69°

Избранные Все

DO NOT EXCEED 10Kg

- Главная
- Медиа
- Комфорт
- Nav
- Тел.
- Автом.
- Прил.

Низ. 75° НАРУЖЕ | 10:56 FM EmaratFM | 69°

Избранные | Все

DO NOT EXCEED 10Kg

Медиа
Комфорт
Nav
Тел.

Телефон
Android Auto
Device Manager

DO NOT PRESS



Низ. | | | | 75° НАРУЖН. | 10:56 | FM EmaratFM | 69°

Избранные | Все

Главная
Медиа
Комфорт
Nav
Тел.
Автом.
Прил.

Nav
Тел.
Автом.
Система

Автом.
Затемнение зеркала
Камера зад. вида
Настройки

Настройка аудио
Передняя камера
Переключатель сигнала...
Элементы управления



Главная



Медиа



Комфорт



Nav



Тел.



Автом.



Прил.

Низ.

75°
НАРУЖН.

10:56

69°

Источники

Воспроизведение

Просмотр

Настр. аудио

Баланс/
Фейдер

Эквалайзер

Гром. в завис.
от скорости

Компенсац.
ромкости Auh



DO NOT EXCEED OKg

DO NOT PRESS

FLY

Volume control knob with 'VOLUME' and power icon.

| | | | | | | | |
|----------------------------|---|-----------------|------|-----------------|----------------------------|-----------------------|-----|
| FRONT | Icon: Fan with three lines | Red up arrow | OFF | Red up arrow | MODE | Icon: Fan with person | A/C |
| Icon: Fan with three lines | Icon: Fan with three lines and yellow indicator | Blue down arrow | AUTO | Blue down arrow | Icon: Fan with three lines | Icon: Car with fan | |

MUTE A OFF OFF P OFF SCREEN OFF

Bottom row of buttons: MUTE, A OFF, OFF, P OFF, SCREEN OFF.

Touchscreen interface with various icons and controls.



MEDIA



FRONT+REAR

OFF

REAR ONLY

OFF ROAD

SPORT

AUX 3

AUX 4







RUBICON

RUBICON







///ALPINE



WARNING
EYES WITH ADVANCED ASSISTANCE
EYES CAN BE HARMED BY LASER LIGHT FROM THE LASER LIGHTS. ALWAYS WEAR YOUR SAFETY BELT AND ALWAYS WEAR YOUR SEATBELT PROPERLY. ALWAYS USE SEATBELT FOR BEST PROTECTION AGAINST FATALITY.
WARNING ADVANCED ASSISTANCE
ALWAYS WEAR YOUR SEATBELT AND ALWAYS WEAR YOUR SEATBELT PROPERLY. ALWAYS USE SEATBELT FOR BEST PROTECTION AGAINST FATALITY.
MISE EN GARDE
LES YEUX PEUVENT ÊTRE BLESSÉS PAR LA LUMIÈRE LASER. TOUJOURS PORTER VOTRE CEINTURE DE SÉCURITÉ ET TOUJOURS PORTER VOTRE CEINTURE DE SÉCURITÉ DE MANNIÈRE APPROPRIÉE. TOUJOURS UTILISER LA CEINTURE DE SÉCURITÉ POUR LA MEILLEURE PROTECTION CONTRE LA MORT.
MISE EN GARDE LES YEUX PEUVENT ÊTRE BLESSÉS PAR LA LUMIÈRE LASER. TOUJOURS PORTER VOTRE CEINTURE DE SÉCURITÉ ET TOUJOURS PORTER VOTRE CEINTURE DE SÉCURITÉ DE MANNIÈRE APPROPRIÉE. TOUJOURS UTILISER LA CEINTURE DE SÉCURITÉ POUR LA MEILLEURE PROTECTION CONTRE LA MORT.

WARNING
EYES WITH ADVANCED ASSISTANCE
EYES CAN BE HARMED BY LASER LIGHT FROM THE LASER LIGHTS. ALWAYS WEAR YOUR SAFETY BELT AND ALWAYS WEAR YOUR SEATBELT PROPERLY. ALWAYS USE SEATBELT FOR BEST PROTECTION AGAINST FATALITY.
WARNING ADVANCED ASSISTANCE
ALWAYS WEAR YOUR SEATBELT AND ALWAYS WEAR YOUR SEATBELT PROPERLY. ALWAYS USE SEATBELT FOR BEST PROTECTION AGAINST FATALITY.
MISE EN GARDE
LES YEUX PEUVENT ÊTRE BLESSÉS PAR LA LUMIÈRE LASER. TOUJOURS PORTER VOTRE CEINTURE DE SÉCURITÉ ET TOUJOURS PORTER VOTRE CEINTURE DE SÉCURITÉ DE MANNIÈRE APPROPRIÉE. TOUJOURS UTILISER LA CEINTURE DE SÉCURITÉ POUR LA MEILLEURE PROTECTION CONTRE LA MORT.
MISE EN GARDE LES YEUX PEUVENT ÊTRE BLESSÉS PAR LA LUMIÈRE LASER. TOUJOURS PORTER VOTRE CEINTURE DE SÉCURITÉ ET TOUJOURS PORTER VOTRE CEINTURE DE SÉCURITÉ DE MANNIÈRE APPROPRIÉE. TOUJOURS UTILISER LA CEINTURE DE SÉCURITÉ POUR LA MEILLEURE PROTECTION CONTRE LA MORT.

TRUCK







Jeep®

DOT H0388FKC-NH-749

ASH 23



43R-0120269



EQ01488



23



SAH ACOUSTIC

TRANSP. 70% MIN.

MADE IN USA

PG2519033AA

CORNING | Gorilla Glass



RUBICON

A close-up photograph of the front hood of a dark blue vehicle. The word "RUBICON" is prominently displayed in a large, bold, red-outlined font. The car's surface is highly reflective, showing a clear reflection of the text and the surrounding environment. In the background, a blurred scene includes a concrete bridge with metal railings, green trees, and a blue sign with a white arrow pointing upwards. The lighting is bright, suggesting a sunny day.





Jeep

WRANGLER

RAM

WRANGLER



Manufacturer Name **FCA US LLC** اسم الصانع

Model Year **2024** سنة الموديل Label No **160987** رقم البطاقة

Vehicle Type **FCA US LLC JEEP WRANGLER UNLIMITED 3.6L SUV 4WD 4Doors** طراز المركبة

Fuel Economy اقتصاد الوقود



Fuel Type نوع الوقود **Gasoline Euro IV بنزين**
Fuel Economy اقتصاد الوقود **9.4 km/L**
Vehicle Class فئة المركبة **Light Truck**



إزالة أو تغطية أو إتلاف هذه البطاقة قبل البيع يعرض للملاحقة القانونية
Removing, covering or damaging this label before sale is punishable by law







Jeep

WRANGLER

ALL-TERRAIN

BFGOODRICH

T/A
KO2







لمشاهدة صورة السيارة بزاوية 360 درجة إضغط على الصورة أعلاه

Для просмотра автомобиля в формате 360°, пожалуйста, нажмите на фото выше.

To view the 360° degree please press on the picture above

2024 JEEP WRANGLER UNLIMITED RUBICON XTREME V6 3.6L GCC 0km

Бренд: Jeep

Brand: Jeep

الماركة جيب

Категория: Wrangler Unlimited

Category : Wrangler Unlimited

الفئة: رانجلر أنلملتد

Модель: Rubicon Xtreme

Model : Rubicon Xtreme

الموديل: روبيكون اكستريم

Год: 2024

Year: 2024

السنة: 2024

Километров: 0 Km

Kilometers: 0 Km

كيلومترات: 0 كم

Двери: 4 Doors

Doors: 4 Doors

عدد الأبواب: أربعة أبواب

Цвет: Черный

Color: Black

اللون : أسود

Цилиндр: 6 Cylinders

Cylinder: 6 Cylinders

عدد الأسطوانات: 6 أسطوانات

Лошадиные силы: 285 HP

Horsepower: 285 HP

عدد الأحصنة: 285 حصان

Трансмиссия: Автоматическая

Transmission: Automatic

نوع النقل : نقل أوتوماتيكي

Топливо: Бензин

Fuel: Gasoline

المواصفات الإقليمية: خليجية

4X4

4 Wheel Drive 4X4

نوع الوقود: بنزين

دفع رباعي 4X4

2024 JEEP WRANGLER UNLIMITED RUBICON XTREME V6 3.6L GCC 0km

NAPPA LEATHER SEATS

BLACK

MIDDLE EAST EQUIPMENT GROUP

XTREME 35 TIRE PACKAGE

CONVENIENCE GROUP

TECHNOLOGY GROUP

SAFETY GROUP

SMOKER'S GROUP

FMVSS MIDDLE EAST GROUP

AUX BATTERY

SELEC-SPEED (TM) CONTROL

ANTI-LOCK 4-WHEEL DISC PERF BRAKES

PREMIUM DOOR TRIM PANEL

MOPAR HARDTOP HEADLINER

FREEDOM PANEL STORAGE BAG

REMOVABLE ASH TRAY

LEATHER WRAPPED PARK BRAKE HANDLE

LEATHER WRAPPED SHIFT KNOB

MOPAR JACK SPACER

#1 SEAT FOAM CUSHION

ALL AUTOMATIC TRANSMISSIONS

8-SPD AUTO 850RE TRANS (MAKE)

4:1 ROCK-TRAC HD FULL TIME 4WD SYS

4.56 REAR AXLE RATIO

3.6L V6 24V VVT ENGINE UPG I W/ESS

SOLAR CONTROL GLASS

REAR WINDOW DEFROSTER

REAR VIEW AUTO DIM MIRROR

BODY COLOR 3-PIECE HARD TOP

200 KPH PRIMARY SPEEDOMETER

REAR WINDOW WIPER/WASHER

CIGAR LIGHTER

230V AUXILIARY POWER OUTLET

GPS NAVIGATION

AIR FILTERING

HEATED FRONT SEATS

POWER 4-WAY DRIVER LUMBAR ADJUST

POWER 4-WAY PASSENGER LUMBAR ADJUST

DRIVER SEAT - POWER ADJUST 8-WAY

FRT PASS SEAT - POWER ADJUST 8-WAY

2024 JEEP WRANGLER UNLIMITED RUBICON XTREME V6 3.6L GCC 0km

EXTERIOR MIRRORS W/ARABIC LETTERING
AUTO HIGH BEAM HEADLAMP CONTROL
REAR FOG LAMPS
FRONT WIDE LICENSE PLATE BRACKET
WRANGLER DECAL
BODY COLOR RUBICON HIGHLINE FLARE
EXPORT EMISSIONS
U.S. EMISSIONS W/OBD 1
ENGINE OIL COOLER
HEATED STEERING WHEEL
ADAPTIVE CRUISE CONTROL W/STOP
WHEEL FLARE EXTENSIONS
BLACK CLEAR COAT
ALPINE PREMIUM AUDIO SYSTEM
APPLE CARPLAY
DISASSOCIATED TOUCHSCREEN DISPLAY
GOOGLE ANDROID AUTO
12.3" TOUCHSCREEN DISPLAY
DIGITAL AUDIO BROADCASTING
INTEGRATED CENTER STACK RADIO

ALL R1 HIGH RADIOS
35" TIRE SUSPENSION
LT315/70R17C 113/110S TIRES
BF GOODRICH BRAND TIRES
UCONNECT 5 NAV W 12.3" DISP(ROW+DAB)
17X8.0 MACHINED WHEELS W/BLK POCKETS
ALL ALUMINUM WHEELS
PARKSENSE REAR PARK ASSIST SYSTEM
BLIND SPOT AND CROSS PATH DETECTION
REMOTE START SYSTEM
TIP START
MOPAR HINGE-GATE REINFORCEMENT
MOPAR TIRE RELOCATION KIT
STOP-START DUAL BATTERY SYSTEM
LOCK FUEL CAP W/ DISCRIMINATOR
ARABIC LANGUAGE
INTEGRATED OFF-ROAD CAMERA
INTEGRATED VOICE COMMAND W/BLUETOOTH
MANUF STATEMENT OF ORIGIN
4 ADDITIONAL GALLONS OF GAS

2024 JEEP WRANGLER UNLIMITED RUBICON XTREME V6 3.6L GCC 0km

BEAD-LOCK

Gorilla Glass Windshield

NAPPA LEATHER SEATS

Зимний Пакет

Подогрев Сидений

Рулевое Колесо с Подогревом

Боковые Зеркала с Подогревом

Дистанционный Запуск Двигателя

Система Мониторинга Слепых Зон

Бесключевой Доступ

Регулировка Режимов Вождения

Ограничитель Скорости

Адаптивный Круиз-контроль

камера переднего вида

Камера Заднего Вида

Блокировка Дифференциала

ALPINE Премиальная Мультимедийная Система

Датчик Давления в Шинах

Система «Старт-Стоп»

12.3 Сенсорный Экран

Apple CarPlay

Android Auto

2024 JEEP WRANGLER UNLIMITED RUBICON XTREME V6 3.6L GCC 0km

الأداء:

ناقل حركة أوتوماتيكي ب 8 سرعات
سعة المحرك: 3.6 لتر
عدد الأسطوانات: 6 أسطوانات
عدد الأحصنة: 285 حصان
العزم: 353 نيوتن/متر
دفع رباعي

* المواصفات الإضافية:

BEAD-LOCK
Gorilla Glass Windshield
Off-Road Pages
مراتب سوداء من جلد النابا
مثبت سرعة تكييفي
نظام الدفلوك Differential Lock
خاصية الثبات الإلكتروني SWAY BAR
خاصية الطرقات الوعرة Off-Road Plus
كاميرا أمامية + خلفية
وضعية قيادة متعددة
نظام البطارية المزدوج للبدء والتوقف
خاصية الكشف عن النقطة العمياء
عوازل حرارية للسقف
نظام صوتي متقدم من Alpine
خاصية تدفئة المراتب
خاصية تدفئة المقود
خاصية تسخين المرايا الجانبية

2024 JEEP WRANGLER UNLIMITED RUBICON XTREME V6 3.6L GCC 0km

دخول بصمة
التشغيل عن بعد
نظام تحديد المواقع والملاحة
وسائد هوائية أمامية
مآخذ كهربائية إضافية
فرامل متقدمة عالية الأداء
تكييف هواء مع تحكم تلقائي بدرجة الحرارة
عجلات قياس 17 بوصة

نظام للمساعدة على الركن الخلفي
شاشة كبيرة تعمل باللمس مقاس 12.3 بوصة
آمر صوتي متكامل مع بلوتوث
مثبت سرعة
إنارة LED
اللغة العربية
مراتب كهربائية متعددة الوضعيات
أبل كاربلاي + أندرويد أوتو

AUTOMAX®

The Boutique Of Muscle Cars, Truck Fanatics & German Automotive Experts.



نتكلم اللغة العربية

WE SPEAK ENGLISH

ON PARLE LE FRANCAIS

Nosotros hablamos español

мы говорим по-русски

biz o'zbek tilida

gaplashamiz

हम हिंदी बोलते हैं



automaxgroup.me



[automax group](https://www.youtube.com/automaxgroup)



[automax.dxb](https://www.snapchat.com/add/automax.dxb)



[Automax_LLC](https://www.telegram.com/Automax_LLC)



[+971 50 602 7200](https://www.whatsapp.com/+971506027200)



[automax.dxb](https://www.instagram.com/automax.dxb)



[automax.dxb](https://www.facebook.com/automax.dxb)



[automax.dxb](https://www.tiktok.com/automax.dxb)



[automax_dxb](https://www.x.com/automax_dxb)



[automax group L.L.C](https://www.linkedin.com/company/automax-group-l-l-c)

New Auto Market - Dubai - United Arab Emirates

[Directions](#)