



































Jeep



VOLUME  
FRONT  
OFF  
AUTO

MUTE OFF OFF P OFF

FRONT-REAR OFF AUX 1 AUX 2







Jeep



SET+

CANC



RES

SET-







W 1.0 Speedometer 80°F

0 km/h

OK for MPH

P 26 km

Fuel gauge showing approximately 1/4 tank. Temperature gauge showing 80°F.



ON OFF

WIPER

WIPER

WIPER





W 2.0 Vehicle Info 80°F

39 39  
39 38  
psi

Tyre pressure  
P  
26 km

H  
C

F  
E



ON OFF

OFF

FRONT WIPER

FRONT WIPER





2H  
4H 4L  
AUTO PAI TIM  
N

A gear selector display showing '2H', '4H', '4L', 'AUTO', 'PAI', 'TIM', and 'N'.

W 2.0 Vehicle Info 80°F

192°F

Coolant Temp

P 26 km

H C F E

A central digital display area. At the top, it shows 'W', '2.0', 'Vehicle Info', and '80°F'. Below this is a circular gauge for 'Coolant Temp' showing '192°F'. Underneath the gauge is the text 'Coolant Temp' and a progress bar. At the bottom, it shows 'P' and '26 km'. On the left and right sides of the central area are vertical fuel level indicators labeled 'H', 'C', 'F', and 'E'.



ON  
PULL  
OFF

Control stalk buttons for various functions, including 'ON', 'PULL', and 'OFF'.





W 2.0 Vehicle Info 80°F

Oil Pressure  
29 psi

P  
26 km

The central display features a compass icon (W), a gear indicator (2.0), the text "Vehicle Info", and a temperature reading of 80°F. Below this is an oil pressure gauge with a needle at 29 psi and an oil can icon. A fuel gauge is partially visible on the right. At the bottom, a gear indicator shows "P" and a range of 26 km.







W

2.0

Vehicle Info

80°F



Battery Voltage

P  
26 km











W 3.0 Off Road 80°F

H C F E

Pitch & Roll  
P  
26 km

The central instrument cluster displays vehicle status. At the top, it shows a compass pointing West (W), a gear indicator for 3.0, the mode 'Off Road', and a temperature of 80°F. Below this are two circular gauges showing pitch and roll angles, both at 0°. On either side are fuel level gauges labeled H, C, F, and E. At the bottom, it shows 'Pitch & Roll' with a green indicator, a gear indicator 'P', and a distance of 26 km.



ON OFF

WIPER

REAR WIPER

The bottom right corner shows control stalks for the front and rear wipers, with 'ON' and 'OFF' positions indicated.



DO NOT PRESS

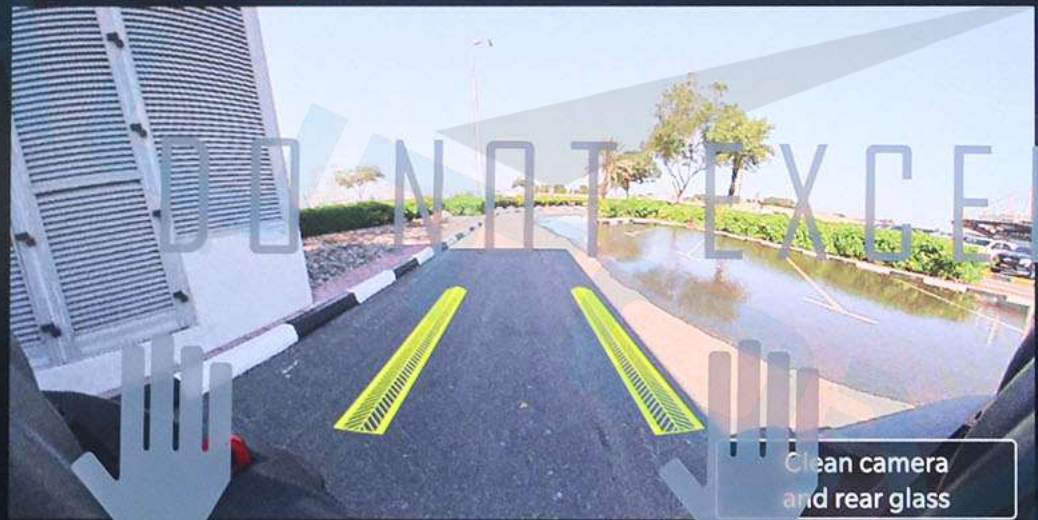

Clean camera and rear glass

Jeep





DO NOT PRESS

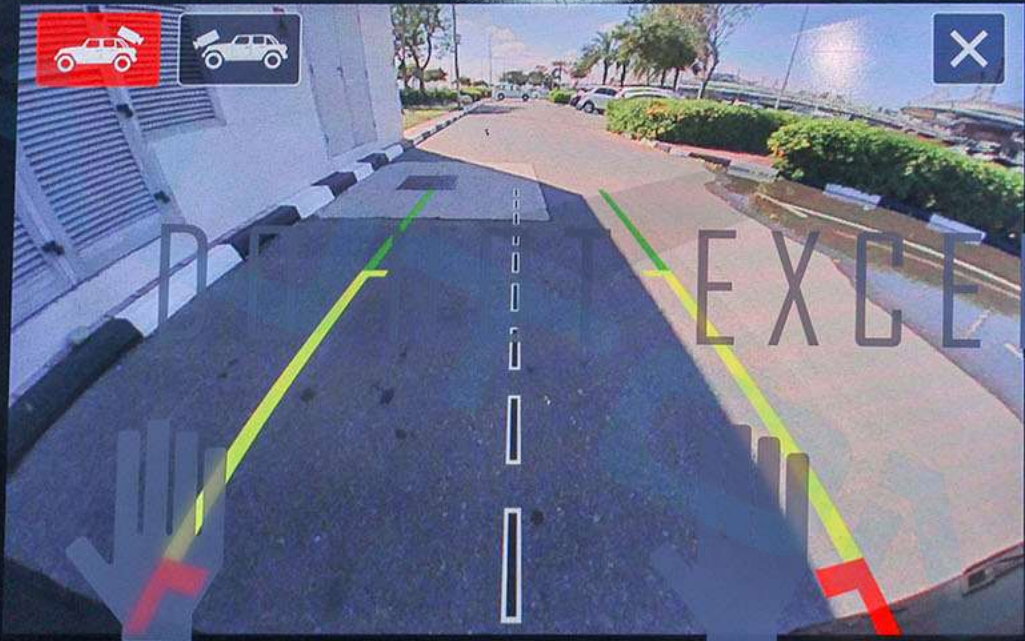

EXCEEDED Jeep





- Home
- Media
- Comfort
- Nav
- Phone
- Vehicle
- Apps

LO 75° OUT | 10:53 EmaratFM | 69°

Search

Manama Street  
22 Street  
31 Street  
24d Street  
27c Street  
25c Street  
23 Street  
36c Street  
Nadd Al Hamar Road

DO NOT EXCEED 10Kg

3D

40

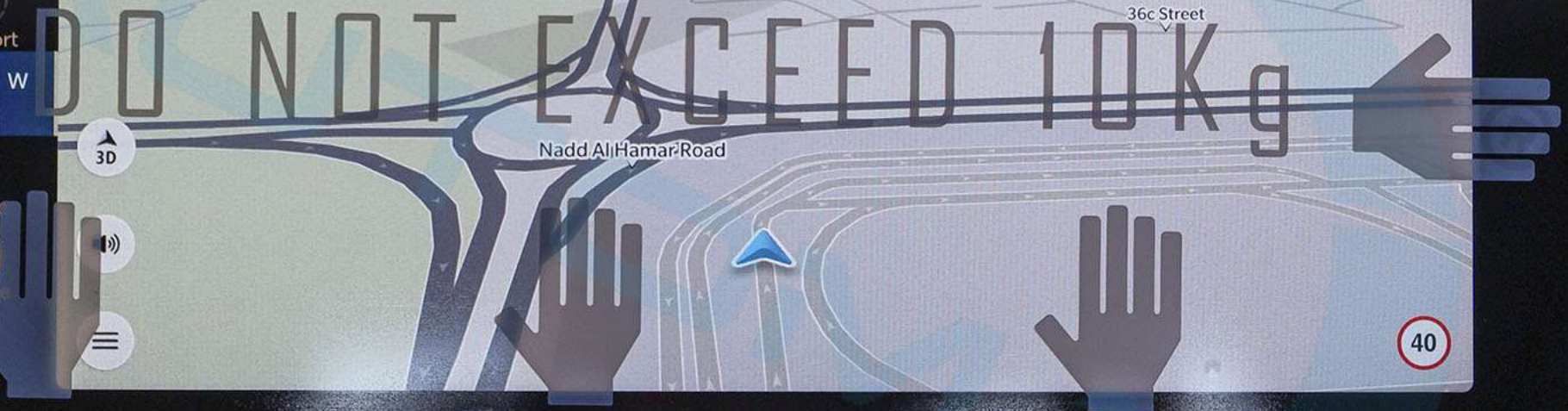



DO NOT PRESS

- Home
- Media
- Comfort
- Nav
- Phone
- Vehicle
- Apps

LO 75° OUT | 10:53 EmaratFM | 69°

Favorites All

Media

- Comfort
- AM Radio
- Audio Settings
- Auxiliary Cable
- Bluetooth
- Nav
- Phone
- DAB
- Device Manager
- FM Radio
- Media







Home



Media



Comfort



Nav



Phone



Vehicle



Apps

LO



75°  
OUT

10:53



EmaratFM



69°

DO NOT EXCEED 10 Kg



Heat



Heat

Max A/C

A/C

Rear

Sync

Off



1

2

3



4

5

6

7

Auto





DO NOT PRESS

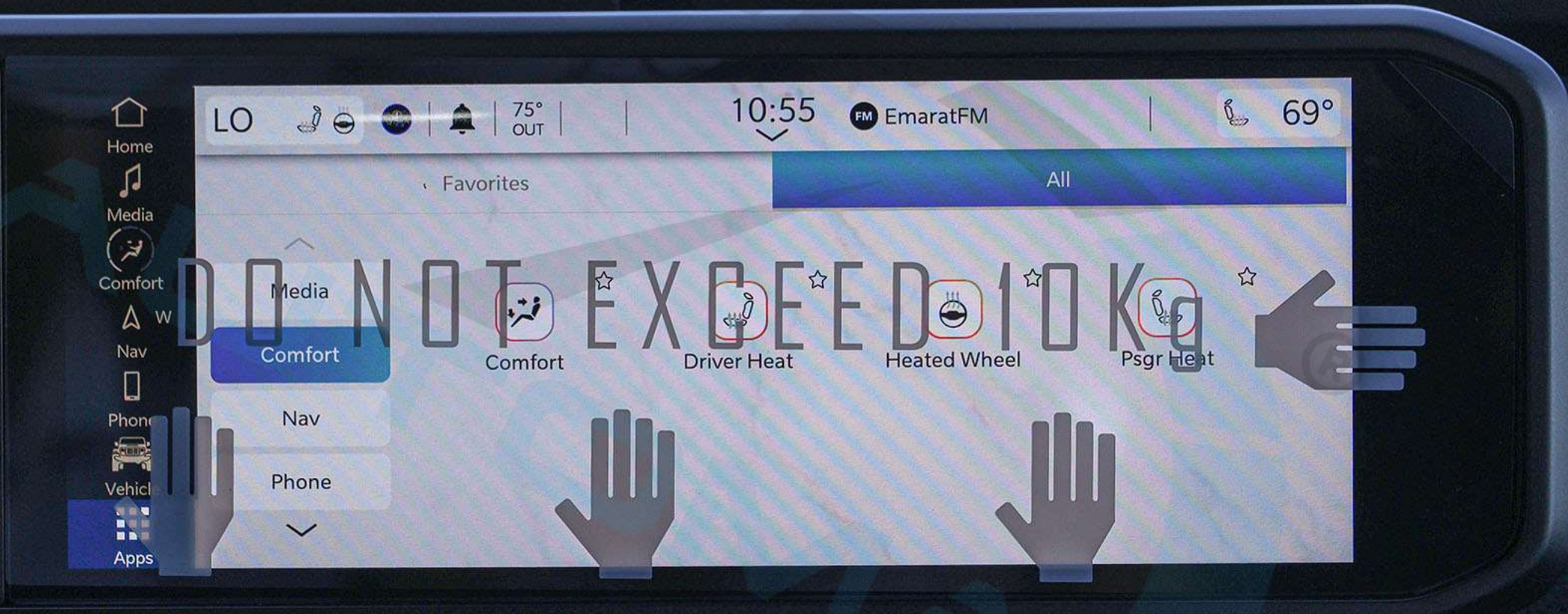

Home



Media



Comfort



Nav



Phone



Vehicle



Apps

LO



75°  
OUT

10:55



EmaratFM



69°

Favorites

All

Media

Comfort

Nav

Phone



Comfort

Driver Heat

Heated Wheel

Psgr Heat

DO NOT EXCEED 100 Km/h



LO [Icons] 75° OUT | 10:52 FM EmaratFM | 69°

Dashboard

Controls

Settings

DO NOT EXCEED 10Kg

Mirror Dimmer

Forward Facing Camera

Rear View Camera

- Home
- Media
- Comfort
- Nav
- Phone
- Vehicle
- Apps

DO NOT PRESS

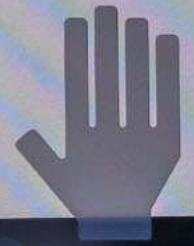



DO NOT PRESS



Home



Media



Comfort



Nav



Phone



Vehicle



Apps

LO



75°  
OUT

10:52

FM EmaratFM



69°

Dashboard

Controls

Settings



OFFROAD  
PAGE

DO NOT EXCEED 10KG







Home



Media



Comfort



Nav



Phone



Vehicle



Apps

LO

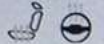

75°  
OUT

10:53



EmaratFM



69°

Favorites

All

DO NOT EXCEED 10Kg



Device Manager



Off Road Pages



Android Auto

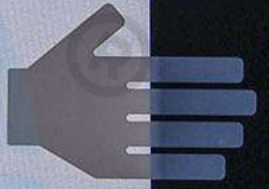

DO NOT PRESS



DO NOT PRESS

- Home
- Media
- Comfort
- Nav
- Phone
- Vehicle
- Apps

LO | 75° OUT | 10:53 | EmaratFM | 69°

Off Road Pages

Vehicle Dynamics

Steering Angle: [Value]

Transfer Case: Unlocked

Sway Bar: Connected

Front Axle Locker: Unlocked

Rear Axle Locker: Unlocked

Pitch & Roll

Front Camera

2H | 55°22'01" | 25°10'07" N | Altitude: -32 m

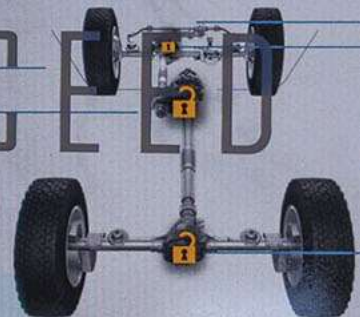

DO NOT EXCEED 10Kg



LO

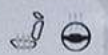

75°  
OUT

10:53

FM EmaratFM

69°

Off Road Pages

- Vehicle Dynamics
- Accessory Gauges**
- Pitch & Roll
- Front Camera

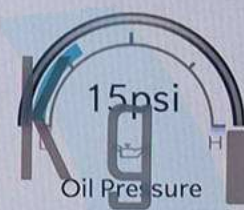
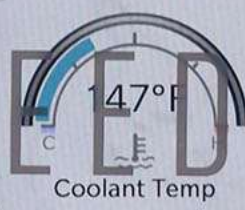
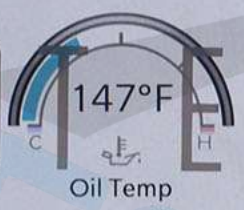

2H 55°22'01" 25°10'07" N Altitude: -32 m



Home



Media



Comfort



Nav



Phone



Vehicle



Apps

DO NOT PRESS



DO NOT PRESS

- Home
- Media
- Comfort
- Nav
- Phone
- Vehicle
- Apps

Off Road Pages

DO NOT EXCEED 10kg

Vehicle Dynamics  
Accessory Gauges

Pitch & Roll

Front Camera

2H 55°22'01" E 25°10'07" N Altitude: -32 m

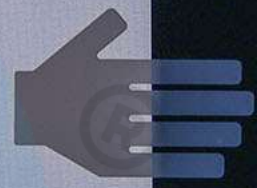
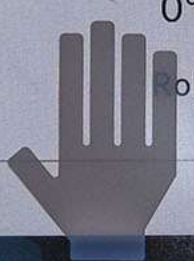



DO NOT PRESS

Home  
Media  
Comfort  
Nav  
Phone  
Vehicle  
Apps

LO 75° OUT | 10:54 EmaratFM | 69°

← Favorites All

Media DAB Device Manager FM Media

Comfort

Nav

Phone USB 1 USB 2





DO NOT PRESS

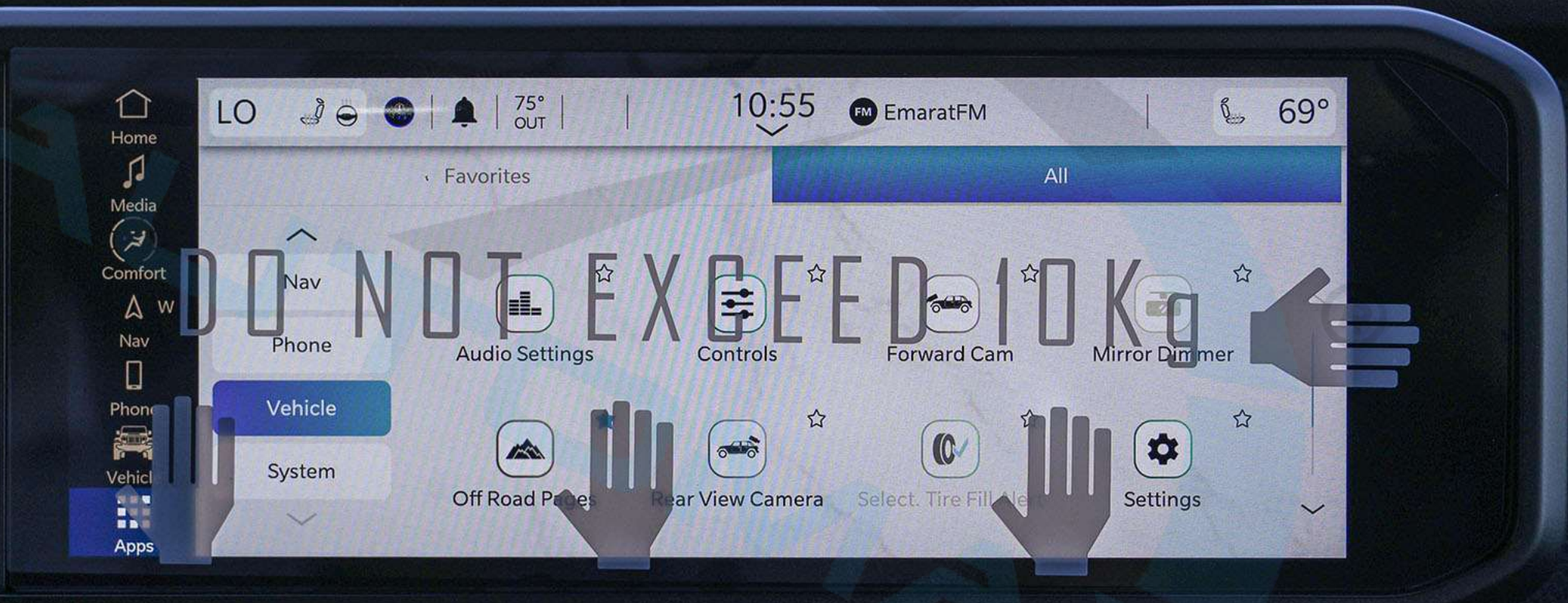

LO | 75° OUT | 10:55 | FM EmaratFM | 69°

Favorites | All

DO NOT EXCEED 100 KM/H

Nav | Phone | Audio Settings | Controls | Forward Cam | Mirror Dimmer

Vehicle | System

Off Road Pages | Rear View Camera | Select. Tire Fill | Settings



DO NOT PRESS

Home  
Media  
Comfort  
Nav  
Phone  
Vehicle  
Apps

LO | 75° OUT | 10:55 | EmaratFM | 69°

Favorites | All

Nav  
Phone  
Vehicle  
System

Driver Profiles  
Software Updates  
Stored Notifications

DO NOT EXCEED 100 Km/h



DO NOT PRESS

- Главная
- Медиа
- Комфорт
- Nav**
- Тел.
- Автом.
- Прил.

Низ. 75° НАРУЖИ | 10:55 | FM EmaratFM | 69°

Поиск

Manama Street

22 Street

31 Street

24d Street

27c Street

25c Street

23 Street

36c Street

Nadd Ali Hamar Road

DO NOT EXCEED 10Kg

3D

40



DO NOT PRESS

- Главная
- Медиа
- Комфорт
- Nav
- Тел.
- АВТОМ
- Прил.

Низ. 75° НАРУЖИ | 10:55 FM EmaratFM | 69°

DO NOT EXCEED 10 Kg

Макс. А/С

A/C

Задний

Синхр. Off < 1 2 3 4 5 6 7 Авт.



- Главная
- Музыка
- Медиа
- Комфорт
- Nav
- Тел.
- Автом.
- Прил.

Низ. 75° НАРУЖН. | 10:55 FM EmaratFM | 69°

Приборная доска | Элементы управления | **Настройки**

Язык (Русский (Россия))

**Дисплей**

Режим дисплея: Авто (selected) / Ручной

Яркость дисплея в ночном режиме: 5

Яркость дисплея в дневном режиме: 10

Режим темы: Светл. / Темн. / Авто (selected)



- Главная
- Медиа
- Комфорт
- Nav
- Тел.
- Автом.**
- Прил.

Off Road Pages

**DO NOT EXCEED 10kg**

- Vehicle Dynamics
- Accessory Gauges
- Pitch & Roll**
- Front Camera

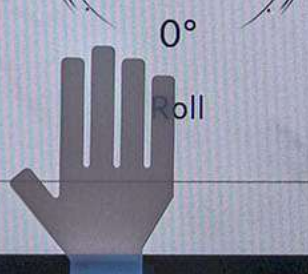

2H 55°22'01" N 25°10'07" E Высота -32 m



- Главная
- Медиа
- Комфорт
- Nav
- Тел.
- Автом.
- Прил.

Низ. 75° НАРУЖН. 10:56 FM EmaratFM 69°

Избранные Все

- Медиа
- Комфорт
- Nav
- Тел.
- Комфорт
- Обог. пасс.
- Обог. водит.
- Обогрев. рул. колесо





- Главная
- Медиа
- Комфорт
- Nav
- Тел.
- Автом.
- Прил.

Низ. | 75° НАРУЖН. | 10:56 | EmaratFM | 69°

Избранные | Все

DO NOT EXCEED 10Kg

Медиа

Комфорт

Nav

Тел.



Nav



DO NOT PRESS



- Главная
- Медиа
- Комфорт
- Nav
- Тел.
- Автом.
- Прил.

Низ. 75° НАРУЖЕ | 10:56 | FM EmaratFM | 69°

Избранные | Все

DO NOT EXCEED 100 Kg

Медиа

Комфорт

Телефон

Android Auto

Device Manager

Nav

Тел.

DO NOT PRESS





Низ. | | | | 75° НАРУЖН. | 10:56 | FM EmaratFM | 69°

Избранные | Все

Главная  
Медиа  
Комфорт  
Nav  
Тел.  
Автом.  
Прил.

Nav  
Тел.  
Автом.  
Система

Автом.  
Затемнение зеркала  
Камера зад. вида  
Настройки

Настройка аудио  
Передняя камера  
Переключатель сигнала...  
Элементы управления





Главная



Медиа



Комфорт



Nav



Тел.



Автом.



Прил.

Низ.



75°  
НАРУЖН.

10:56



69°

Источники

Воспроизведение

Просмотр

Настр. аудио

Баланс/  
Фейдер

Эквалайзер

Гром. в завис.  
от скорости

Компенсац.  
громкости АиХ



DO NOT EXCEED OKg



Volume knob with power icon and "VOLUME" text.

FRONT	Icon: Fan with sun	Up arrow	OFF	Down arrow	MODE	A/C
Icon: Fan with sun	Icon: Fan with sun	Down arrow	AUTO	Up arrow	Icon: Fan with sun	Icon: Car with fan

MUTE    A OFF    OFF    P OFF    SCREEN OFF

Icon: Triangle with exclamation mark

TUNE BROWSE ENTER SCROLL

Buttons for navigation and media control, including a central button with a car icon and a button with a play/pause icon.





FRONT + REAR

4x4 OFF

REAR ONLY

OFF ROAD+

SWAY BAR

MUX 1

2H

AUTO

4N PART TIME

N

4L

+ M D R N P



FRONT+REAR



OFF

REAR ONLY

OFF  
ROAD+

SWAY  
BAR



**+ REAR**

**ONLY**

**OFF  
ROAD+**

**SWAY  
BAR**

**AU**

**AUX**



AUX 1

AUX 3

AUX 2

AUX 4





START  
ENGINE  
STOP

VOLUME

OFF

AUTO

A/C

TUNE  
BROWSE  
ENTER  
SCROLL

FRONT

REAR

MODE

MUTE

OFF

OFF

P  
OFF

SCREEN  
OFF

MEDIA

FRONT + REAR  
OFF

FRONT + REAR

REAR ONLY

2H

4H

AUTO

N

4L

P  
R  
N  
D  
M









RUBICON

RUBICON



















A close-up photograph of a circular speaker grille. The grille is made of a dark, perforated metal mesh. In the center of the grille, there is a small, rectangular badge with the Alpine logo, which consists of four slanted parallel lines followed by the word "ALPINE" in a bold, sans-serif font. The speaker is mounted in a dark, possibly black, plastic housing. The background is out of focus, showing what appears to be the interior of a car with a textured surface.

ALPINE













ALTO

6M1023







**Jeep**®

DOT110388FKC-N1-7498

ASHI 23



43R-0120269



EQ0014088



23



SAH ACOUSTIC

TRANSP. 70% MIN.

MADE IN USA

PG2519033AA

**CORNING | Gorilla Glass**





**RUBICON**

A close-up photograph of the hood of a green Jeep Rubicon. The word "RUBICON" is prominently displayed in a bold, black, sans-serif font with a red outline. The hood is highly reflective, showing clear reflections of the surrounding environment, including green bushes and a blue sky with white clouds. The background is slightly out of focus, showing more greenery and a hint of a paved area.



**Jeep**

**WRANGLER**







TRAIL RATED







**AUTOMAX**  
AUTOMAX.AE © 2021 04 379 8890 L. 021 6 220099







Manufacturer Name: FCA US LLC  
Model Year: 2024  
Label No: 160987

Vehicle Type: FCA US LLC JEEP WRANGLER UNLIMITED 3.6L SUV 4WD 4Doors



**GSO** هيئة التقييس  
لؤل مجلس التعاون لدول الخليج العربية  
GCC Standardization Organization

Fuel Type: Gasoline Euro IV بنزين  
Fuel Economy: 9.4 km/L  
Vehicle Class: Light Truck

إزالة أو تغطية أو إتلاف هذه البطاقة قبل البيع يعرض للملاحقة القانونية  
Removing, covering or damaging this label before sale is punishable by law











Jeep

WRANGLER

All-Terrain T/A

KO2



LT315/70R17(113/105)  
LOAD RANGE G  
DHS

Goodyear

Goodyear









لمشاهدة صورة السيارة بزاوية 360 درجة إضغط على الصورة أعلاه

Для просмотра автомобиля в формате 360°, пожалуйста, нажмите на фото выше.

To view the 360° degree please press on the picture above



# 2024 JEEP WRANGLER UNLIMITED RUBICON XTREME V6 3.6L GCC 0km

Бренд: Jeep

Brand: Jeep

الماركة جيب

Категория: Wrangler Unlimited

Category : Wrangler Unlimited

الفئة: رانجلر أنلملتد

Модель: Rubicon Xtreme

Model : Rubicon Xtreme

الموديل: روبيكون اكستريم

Год: 2024

Year: 2024

السنة: 2024

Километров: 0 Km

Kilometers: 0 Km

كيلومترات: 0 كم

Двери: 4 Doors

Doors: 4 Doors

عدد الأبواب: أربعة أبواب

Цвет: Зеленый

Color: Sarge Green

اللون : أخضر

Цилиндр: 6 Cylinders

Cylinder: 6 Cylinders

عدد الأسطوانات: 6 أسطوانات

Лошадиные силы: 285 HP

Horsepower: 285 HP

عدد الأحصنة: 285 حصان

Трансмиссия: Автоматическая

Transmission: Automatic

نوع النقل : نقل أوتوماتيكي

Топливо: Бензин

Fuel: Gasoline

المواصفات الإقليمية: خليجية

4X4

4 Wheel Drive 4X4

نوع الوقود: بنزين

دفع رباعي 4X4



# 2024 JEEP WRANGLER UNLIMITED RUBICON XTREME V6 3.6L GCC 0km

NAPPA LEATHER SEATS

BLACK

MIDDLE EAST EQUIPMENT GROUP

XTREME 35 TIRE PACKAGE

CONVENIENCE GROUP

TECHNOLOGY GROUP

SAFETY GROUP

SMOKER'S GROUP

FMVSS MIDDLE EAST GROUP

AUX BATTERY

SELEC-SPEED (TM) CONTROL

ANTI-LOCK 4-WHEEL DISC PERF BRAKES

PREMIUM DOOR TRIM PANEL

MOPAR HARDTOP HEADLINER

FREEDOM PANEL STORAGE BAG

REMOVABLE ASH TRAY

LEATHER WRAPPED PARK BRAKE HANDLE

LEATHER WRAPPED SHIFT KNOB

MOPAR JACK SPACER

#1 SEAT FOAM CUSHION

ALL AUTOMATIC TRANSMISSIONS

8-SPD AUTO 850RE TRANS (MAKE)

4:1 ROCK-TRAC HD FULL TIME 4WD SYS

4.56 REAR AXLE RATIO

3.6L V6 24V VVT ENGINE UPG I W/ESS

SOLAR CONTROL GLASS

REAR WINDOW DEFROSTER

REAR VIEW AUTO DIM MIRROR

BODY COLOR 3-PIECE HARD TOP

200 KPH PRIMARY SPEEDOMETER

REAR WINDOW WIPER/WASHER

CIGAR LIGHTER

230V AUXILIARY POWER OUTLET

GPS NAVIGATION

AIR FILTERING

HEATED FRONT SEATS

POWER 4-WAY DRIVER LUMBAR ADJUST

POWER 4-WAY PASSENGER LUMBAR ADJUST

DRIVER SEAT - POWER ADJUST 8-WAY

FRT PASS SEAT - POWER ADJUST 8-WAY



# 2024 JEEP WRANGLER UNLIMITED RUBICON XTREME V6 3.6L GCC 0km

EXTERIOR MIRRORS W/ARABIC LETTERING  
AUTO HIGH BEAM HEADLAMP CONTROL  
REAR FOG LAMPS  
FRONT WIDE LICENSE PLATE BRACKET  
WRANGLER DECAL  
BODY COLOR RUBICON HIGHLINE FLARE  
EXPORT EMISSIONS  
U.S. EMISSIONS W/OBD 1  
ENGINE OIL COOLER  
HEATED STEERING WHEEL  
ADAPTIVE CRUISE CONTROL W/STOP  
WHEEL FLARE EXTENSIONS  
SARGE GREEN CLEAR COAT  
ALPINE PREMIUM AUDIO SYSTEM  
APPLE CARPLAY  
DISASSOCIATED TOUCHSCREEN DISPLAY  
GOOGLE ANDROID AUTO  
12.3" TOUCHSCREEN DISPLAY  
DIGITAL AUDIO BROADCASTING  
INTEGRATED CENTER STACK RADIO

ALL R1 HIGH RADIOS  
35" TIRE SUSPENSION  
LT315/70R17C 113/110S TIRES  
BF GOODRICH BRAND TIRES  
UCONNECT 5 NAV W 12.3" DISP(ROW+DAB)  
17X8.0 MACHINED WHEELS W/BLK POCKETS  
ALL ALUMINUM WHEELS  
PARKSENSE REAR PARK ASSIST SYSTEM  
BLIND SPOT AND CROSS PATH DETECTION  
REMOTE START SYSTEM  
TIP START  
MOPAR HINGE-GATE REINFORCEMENT  
MOPAR TIRE RELOCATION KIT  
STOP-START DUAL BATTERY SYSTEM  
LOCK FUEL CAP W/ DISCRIMINATOR  
ARABIC LANGUAGE  
INTEGRATED OFF-ROAD CAMERA  
INTEGRATED VOICE COMMAND W/BLUETOOTH  
MANUF STATEMENT OF ORIGIN  
4 ADDITIONAL GALLONS OF GAS



# 2024 JEEP WRANGLER UNLIMITED RUBICON XTREME V6 3.6L GCC 0km

BEAD-LOCK

Gorilla Glass Windshield

Зимний Пакет

Подогрев Сидений

Рулевое Колесо с Подогревом

Боковые Зеркала с Подогревом

Дистанционный Запуск Двигателя

Система Мониторинга Слепых Зон

Бесключевой Доступ

Регулировка Режимов Вождения

Ограничитель Скорости

Адаптивный Круиз-контроль

камера переднего вида

Камера Заднего Вида

Блокировка Дифференциала

ALPINE Премиальная Мультимедийная Система

Датчик Давления в Шинах

Система «Старт-Стоп»

12.3 Сенсорный Экран

Apple CarPlay & Android Auto



# 2024 JEEP WRANGLER UNLIMITED RUBICON XTREME V6 3.6L GCC 0km

الأداء:

ناقل حركة أوتوماتيكي ب 8 سرعات  
سعة المحرك: 3.6 لتر  
عدد الأسطوانات: 6 أسطوانات  
عدد الأحصنة: 285 حصان  
العزم: 353 نيوتن/متر  
دفع رباعي

\* المواصفات الإضافية:

BEAD-LOCK  
Gorilla Glass Windshield  
Off-Road Pages  
مثبت سرعة تكييفي  
نظام الدفلوك Differential Lock  
خاصية الثبات الإلكتروني SWAY BAR  
خاصية الطرقات الوعرة Off-Road Plus  
كاميرا أمامية + خلفية  
وضعية قيادة متعددة  
نظام البطارية المزدوج للبدء والتوقف  
خاصية الكشف عن النقطة العمياء  
عوازل حرارية للسقف  
نظام صوتي متقدم من Alpine  
خاصية تدفئة المرايا  
خاصية تدفئة المقود  
خاصية تسخين المرايا الجانبية  
مرايا جلد بالون الأسود



# 2024 JEEP WRANGLER UNLIMITED RUBICON XTREME V6 3.6L GCC 0km

دخول بصمة  
التشغيل عن بعد  
نظام تحديد المواقع والملاحة  
وسائد هوائية أمامية  
مآخذ كهربائية إضافية  
فرامل متقدمة عالية الأداء  
تكييف هواء مع تحكم تلقائي بدرجة الحرارة  
عجلات قياس 17 بوصة

نظام للمساعدة على الركن الخلفي  
شاشة كبيرة تعمل باللمس مقاس 12.3 بوصة  
آمر صوتي متكامل مع بلوتوث  
مثبت سرعة  
إنارة LED  
اللغة العربية  
مراتب كهربائية متعددة الوضعيات  
أبل كاربلاي + أندرويد أوتو



# AUTOMAX®

The Boutique Of Muscle Cars, Truck Fanatics & German Automotive Experts.



نتكلم اللغة العربية

WE SPEAK ENGLISH

ON PARLE LE FRANCAIS

Nosotros hablamos español

мы говорим по-русски

biz o'zbek tilida

gaplashamiz

हम हिंदी बोलते हैं



[automaxgroup.me](http://automaxgroup.me)



[automax group](https://www.youtube.com/automaxgroup)



[automax.dxb](https://www.snapchat.com/add/automax.dxb)



[Automax\\_LLC](https://www.telegram.com/Automax_LLC)



[+971 54 279 8990](https://www.whatsapp.com/+971542798990)



[automax.dxb](https://www.instagram.com/automax.dxb)



[automax.dxb](https://www.facebook.com/automax.dxb)



[automax.dxb](https://www.tiktok.com/automax.dxb)



[automax\\_dxb](https://www.twitter.com/automax_dxb)



[automax group L.L.C](https://www.linkedin.com/company/automax-group-l-l-c)

New Auto Market - Dubai - United Arab Emirates

[Directions](#)